



*
CITYFUTUREs



Annual Report 2010

CITY FUTURES RESEARCH CENTRE

Faculty of the Built Environment, University of New South Wales

ISSN 1838-1219

June 2011



UNSW
THE UNIVERSITY OF NEW SOUTH WALES

Never Stand Still

Faculty of Built Environment

TABLE OF CONTENTS

INTRODUCTION AND SUMMARY	1
CENTRE STAFF, VISITORS AND ASSOCIATES, 2010	4
CITY FUTURES MANAGEMENT BOARD.....	5
CENTRE STAFF 2010.....	5
VISITING STAFF 2010.....	6
FBE ASSOCIATE STAFF 2010	7
RESEARCH PARTNERSHIPS	7
PERFORMANCE AGAINST TARGETS.....	10
CITY FUTURES WEBSITE.....	13
HOME MODIFICATION INFORMATION CLEARINGHOUSE'S WEBSITE	16
DESCRIPTION OF RESEARCH PROJECTS IN PROGRESS OR COMPLETED IN 2010	18
CITY FUTURES - PROJECTS COMPLETED DURING 2010	19
CITY FUTURES - PROJECTS ONGOING AT END OF 2010.....	23
HEALTHY BUILT ENVIRONMENTS PROGRAM - PROJECTS COMPLETED DURING 2010	30
HEALTHY BUILT ENVIRONMENTS PROGRAM - PROJECTS ONGOING AT END OF 2010	31
HOME MODIFICATION INFORMATION CLEARINGHOUSE'S - PROJECTS COMPLETED DURING 2010	32
HOME MODIFICATION INFORMATION CLEARINGHOUSE'S - PROJECTS ONGOING AT END OF 2010.....	35
DISSEMINATION: PUBLICATIONS AND PRESENTATIONS	37
REFEREED PUBLICATIONS	38
REFEREED CONFERENCE PRESENTATIONS	40
OTHER CONFERENCE PRESENTATIONS.....	41
COMMUNITY AND PRACTICE PRESENTATIONS.....	43
CONFERENCES AND SEMINARS	45



TEACHING AND SUPERVISION48

SUPERVISION OF PhD STUDENTS..... 50

SUPERVISION OF MASTERS BY RESEARCH STUDENTS..... 52

TEACHING 52

STATEMENT OF FINANCIAL PERFORMANCE.....55

OVERVIEW 56

STATEMENT OF IN-KIND CONTRIBUTIONS 56

STATEMENT OF FINANCIAL PERFORMANCE 2010 CITY FUTURES..... 57

STATEMENT OF FINANCIAL PERFORMANCE 2010 HEALTHY BUILT ENVIRONMENTS PROGRAM 58

STATEMENT OF FINANCIAL PERFORMANCE 2010 HOME MODIFICATION INFORMATION CLEARINGHOUSE..... 58

STATEMENT OF FINANCIAL PERFORMANCE 2010 TOTAL CITY FUTURES RESEARCH CENTRE (CF, HBEP & HMIInfo)..... 59

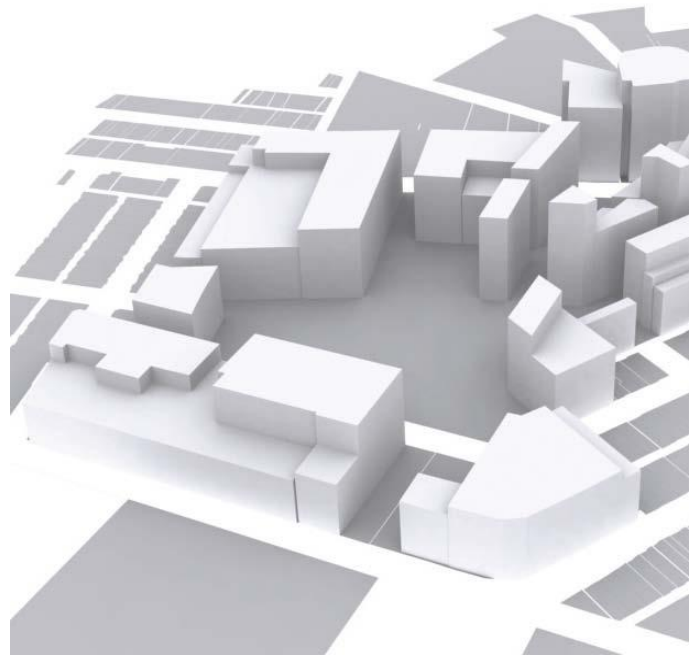

1

INTRODUCTION AND SUMMARY

1

INTRODUCTION AND SUMMARY



Prof Bill Randolph, Director
City Futures Research
Centre

Welcome to the City Futures Research Centre's 2010 Annual Report. 2010 was an year of major growth for the Centre with the addition of significant additional capacity and several key successes in terms of new staff and projects. In particular, the year saw two new funded entities joining the group, both in the early part of the year. In January, the *Home Modification Information Unit* (HMInfo), headed by A/Prof Catherine Bridge, merged with the Centre. Katy brings a team of research and support staff with a focus on the key areas of accessibility and mobility issues in the built environment. A core role of the Unit is the *Clearinghouse* project, funded by the NSW Department of Human Service - Ageing, Disability and Home Care, to develop a knowledge base and information on home modification for those with mobility impairment. It is hoped that this group will form the core of innovative research in the *Enabling Design* area to undertake research on how buildings and building products can be better designed to accommodate the needs of all ages and needs requirements.

At the same time, the *Healthy Built Environments Program* (HBEP), headed by A/Prof Susan Thompson, was established as a result of the successful application to the NSW Department of Health for a new research initiative dedicated to research on how the design of cities can make them more supportive of healthy ways of living. HBEP is funded for five years to work with the Department to develop new research in this area. Together with an ARC Linkage project with NSW Landcom, the National Health Foundation and SW Sydney Area Health Authority which started at the same time, the new group promises to generate a highly innovative area of research into the health and well being in the built environment.

Both these initiatives broaden the scope of the Centre significantly and also bring new staff into the City Futures team. They have also resulted in a more complex organisational structure that has meant a degree of restructuring to incorporate these new entities into the Centre's financial and administrative structure. Thus restructuring will continue into 2011.

In the established 'core' City Futures group, staffing changes included the appointment of Dr Gethin Davison who commenced employment as a Research Fellow in August 2010. Gethin holds a PhD in urban planning and design from University of Melbourne, where he also taught urban design and worked as a research assistant in the Faculty of Architecture Building and Planning. In addition, Dr Edgar Liu was promoted to Research Associate with the Centre in July 2010 and Andrew Tice, our Senior Research Officer, went part time to start a PhD.

Further external appointments to our visiting staff included Prof Tony Capon from the ANU (and Co-Director of HBEP), David Lilley and Bernie Coates, both from Housing NSW, and Francesco Andreone, one of Sydney's leading strata lawyers. Along with HMInfo and HBEP, we extend a warm welcome to these new members of the City Futures team and wish them a very successful association with the Centre. Altogether, 20 new staff and visitors joined the centre, a major step up in our capacity, which totalled some 36 staff and visitors by the end of the year.

However, we also saw some staff members leave. Dr Tony Gilmour, Research Associate, left to join Elton Consulting in February; Dr Peter Rickwood, Research Associate, left for UTS in April and Dr John Mitchell, Senior Research Fellow, moved into a part time role in the Faculty in March. We wish them well in their new roles. More up to date news, reports and staff information can be accessed throughout the year on our website: www.cityfutures.net.au.

2010 also marked the year that City Futures PhD students recorded their first completions. During the year, PhDs were awarded to three City Futures post-grads: Dr Ting Xu, Dr Lucy Groenhart and Dr Aida Morden. This is a very good outcome for the Centre and marks the fulfillment of a commitment by the Centre to contribute to the development of a new generation of Australian urban researchers.



Healthy Built Environments
Program (HBEP)



Home Modification
Information Unit (HMInfo)

We wish them all the best for a fulfilling future career and we look forward to a continuing stream of successful completions in the years to come.

Performance against our target performance indicators also indicated significant progress (see page 12). Highlights are the 54% boost in external research income from \$1.282m in 2009 to \$1.974m in 2010; a total income result of \$2.353m for the year; a 37% increase in DEST recognised publications to 41; a 69% increase in media references to 61; and a small, but significant, increase in international conference presentations. Post graduate research student numbers supervised by Centre staff also jumped to 25. In part, the significant improvement in measured outputs resulted from the addition of the HMIInfo and HBEP initiatives to the City Futures operation. The expansion of the Centre has also meant a continued broadening of the research income base of the Centre, as the following figure shows. Together with a solid outcome from the existing City Futures group, these results augur well for the future.

City Futures Income Sources 2004-2010
Total = \$10.18 Million (including HMIInfo and HBEP funding)

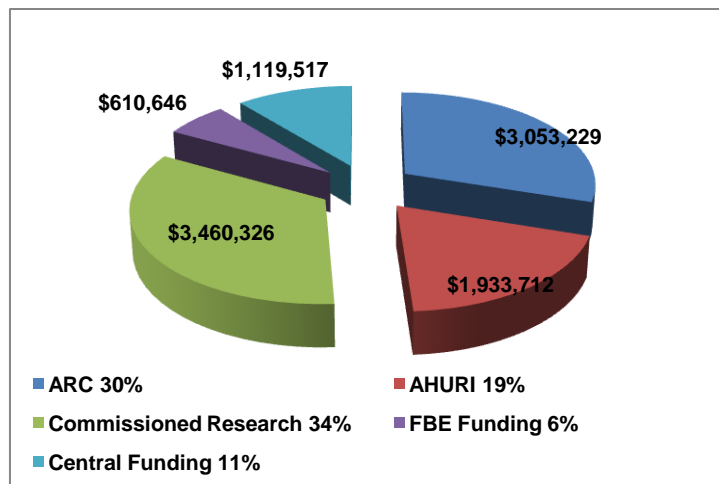

But most importantly, the Centre has extended its impact in the broader policy community in which it works. The range of conference and seminar presentations and our media presence gives some measure of that. But we also continue to engage with policy makers and practitioners at the highest level in NSW and beyond in terms of advice and inputs to policy development.

2010 was therefore a significant year in terms of the development of the Centre and the progress reported here sets us up well for the Centre Review which is due in 2011 and the development of the next three year Business Plan. However, little of what we do at City Futures could have been achieved without the support from the many and varied partner organisations and colleagues with whom we work to develop and deliver the research noted in this, our fifth, Annual Report.

On behalf of the City Futures team, I would like to extend a very warm thanks to all our external partners and Faculty staff who have worked hard with us to achieve such a significant outcome.

Prof Bill Randolph
 Director
 City Futures Research Centre

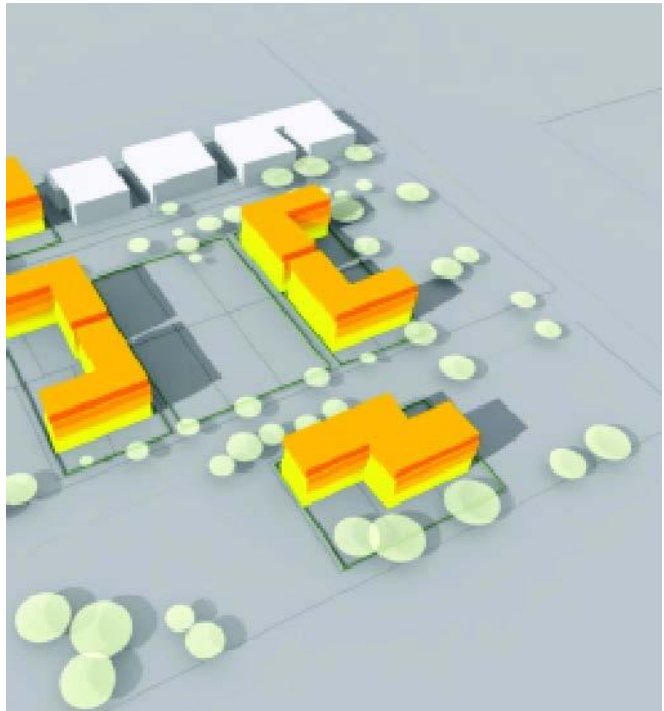

2

CENTRE STAFF, VISITORS AND ASSOCIATES, 2010

2

CENTRE STAFF, VISITORS AND ASSOCIATES, 2010

CITY FUTURES MANAGEMENT BOARD

- **Prof Alec Tzannes**, (Chair), Dean, Faculty of the Built Environment
- **A/Prof Catherine Bridge**, Director, Home Modification Information Clearinghouse
- **A/Prof Linda Corkery**, Head of Discipline Planning, Urban Design, Landscape, and Construction Management and Property
- **Prof Robert Freestone**, Professor, Planning Program, Faculty of the Built Environment
- **Dr Peter Graham**, Head of Discipline Architecture and Design
- **A/Prof Bruce Judd**, Visiting Senior Research Fellow
- **Prof Jane Marceau**, Visiting Professorial Fellow
- **Dr Simon Pinnegar**, Deputy Director, City Futures Research Centre
- **Prof Bill Randolph**, Director City Futures Research Centre, Associate Dean of Research, Faculty of the Built Environment
- **A/Prof Susan Thompson**, Director, Healthy Built Environments Program
- **Bronwen Turner**, Built Environment Research Manager
- **Shelly Wood**, General Manager, Faculty of the Built Environment

Three formal Management Board Meetings took place in 2010 on 19th March, 28th September and 10th December.

CENTRE STAFF 2010

CITY FUTURES CORE STAFF

- **Prof Bill Randolph**, Centre Director
- **Dr Simon Pinnegar**, Deputy Director
- **Dr Jack Barton**, Research Fellow
- **Dr Gethin Davison**, Research Fellow (Appointed August 2010)
- **Dr Hazel Easthope**, Research Fellow
- **Dr Tony Gilmour**, Research Associate (Resigned February 2010)
- **Dr Edgar Liu**, Research Officer
- **A/Prof Vivienne Milligan**, A/Prof
- **Dr John Mitchell**, Senior Research Fellow (contract expired March 2010)
- **Dr Peter Rickwood**, Research Associate (Resigned April 2010)
- **Maria Schwensen**, Administrative Coordinator

- **Andrew Tice**, Part time Senior Research Officer / PhD student
- **Dr Ilan Vize**, Research Associate

HEALTHY BUILT ENVIRONMENTS PROGRAM

- **A/Prof Susan Thompson**, Program Director
- **Evan Freeman**, Public Health Officer Trainee, NSW Health and UNSW Faculty of Medicine (six month placement September onwards)
- **Jennifer Manefield**, Research Assistant
- **Dr Lisa Mu**, Public Health Intern, University of British Columbia, Vancouver Canada, (six month placement November onwards)
- **Andrew Wheeler**, Bachelor of Planning Work Experience Student (six month placement August onwards)
- **Joanna York**, Senior Research Officer

HOME MODIFICATION INFORMATION CLEARINGHOUSE

- **A/Prof Catherine Bridge**, Program Director
- **Louisa Achille**, Research Administrator (Resigned September 2010)
- **Phillippa Carnemolla**, Industrial Designer/Research Assistant
- **David Cunningham**, Librarian (commenced June 2010)
- **Laura Davy**, Researcher
- **Susan Mills**, Librarian, (contract expired June 2010)
- **Lyndal Millikan**, Researcher
- **Dr Yong-Mong Jung**, Research Associate
- **Rachel Walls**, Researcher/Research Administrator (commenced September 2010)

VISITING STAFF 2010

- **Francesco Andreone**, Adjunct Associate Professor (appointed November 2010)
- **Dr Raymond Bunker**, Visiting Senior Research Fellow
- **Professor Tony Capon**, Adjunct Professor (appointed February 2010)
- **Bernie Coates**, Visiting Fellow (Appointed July 2010)
- **Prof Michael Evers**, Visiting Professorial Fellow
- **A/Prof Bruce Judd**, Visiting Senior Research Fellow
- **David Lilley**, Visiting Fellow (Appointed July 2010)
- **Prof Jane Marceau**, Visiting Professorial Fellow
- **Dr Judy Stubbs**, Adjunct Senior Research Fellow
- **Prof Patrick Troy**, Visiting Professorial Fellow
- **Prof Jennifer Westacott**, Visiting Professorial Fellow

FBE ASSOCIATE STAFF 2010

In addition to the Centre staff, the following 9 Faculty were actively associated with the Centre during 2010.

- **A/Prof Jane Carthey**, Director of the Centre for Health Assets Australasia (CHAA)
- **A/Prof Linda Corkery**, Head of Program; Landscape Architecture (BLArch)
- **A/Prof Oya Demirbilek**, Associate Professor - Industrial Design Program
- **Prof Rob Freestone**, Planning History and Heritage
- **Dr Peter Graham**, Head of Discipline - Architecture & Design
- **Prof Martin Loosemore**, Construction Management Program
- **Russel Lowe**, Senior Lecturer Architecture Program
- **Jim Plume**, Senior Lecturer
- **Stephen Ward**, Lecturer Industrial Design Program

RESEARCH PARTNERSHIPS

City Futures is engaged in research with a range of academic partners.

AHURI

- **A/Prof Nicole Gurrán**, University of Sydney
- **Dr Susan Green**, Director Nura Gili Indigenous Programs Centre, UNSW
- **A/Prof Kath Hulse**, Swinburne University, Melbourne
- **Dr Keith Jacobs**, University of Tasmania
- **Prof Andrew Jones**, University of Queensland
- **Dr Julie Lawson**, RMIT, Melbourne
- **Dr Alan Morris**, Faculty of Arts and Social Sciences, UNSW
- **Dr Diana Olsberg**, Faculty of Arts and Social Sciences, UNSW
- **Prof Peter Phibbs**, University of Western Sydney
- **Prof Paul Memmott**, University of Queensland
- **Rhonda Phillips**, University of Queensland
- **Juanita Sherwood**, Nura Gili Indigenous Programs Centre, UNSW
- **Dr Max Travers**, University of Tasmania
- **Prof Peter Williams**, Cambridge University, Cambridge UK
- **Prof Paul Flatau**, Murdoch University, Perth

Other active Research Partnerships

- **Prof Christine Bigby**, La Trobe University
- **Dr Mei Boon**, School of Vision Sciences, UNSW
- **A/Prof Ron Cox**, Faculty of Engineering, UNSW and National Climate Change Adaptation Research Facility
- **Prof Stephen Dain**, School of Vision Sciences, UNSW
- **Prof Steven Dovers**, Fenner School, Australian National University
- **Prof Ruth Fincher**, Department of Geography, University of Melbourne
- **Prof Billie Giles-Corti**, University of Western Australia
- **Karen Gillham**, (former) Hunter and New England Area Health Service
- **Prof Brendan Gleeson**, Griffith University
- **Juliet Grant**, NSW Transport and Infrastructure
- **Prof Bin Jalaludin**, (former) Sydney South West Area Health Service
- **Claudine Lyons**, NSW Health
- **Peter McCue**, Premier's Council for Active Living
- **Julie-Anne Mitchell**, National Heart Foundation
- **Karen Paterson**, Division of Local Government, Department of Premier and Cabinet
- **Prof Hal Pawson**, Heriot Watt University, Edinburgh,
- **A/Prof Peter Sainsbury**, (former) Sydney South West Area Health Service
- **Norma Shankie-Williams**, NSW Department of Planning
- **Prof Edward Steinfeld**, University at Buffalo, State University of New York
- **Emma Synnott**, ARUP
- **A/Prof Sarah Thackway**, NSW Health
- **Robyn Vincin**, Planning Institute of Australia

Active Industry/Government Partners

- ARUP
- Australian Government Department of Health and Ageing
- City of Sydney
- Commonwealth Department of Families, Housing, Community Services and Indigenous Affairs (FaHCSIA)
- Commonwealth Department of Health and Ageing
- Council on the Ageing (COTA) NSW
- Department of Human Services - Ageing, Disability and Home Care (NSW Government)
- Department of Lands
- Department of Veterans' Affairs
- Disability Council of NSW



- Division of Local Government – NSW Department of Premier and Cabinet
- GWA Kitchens and Bathrooms (Caroma)
- Housing NSW
- Hunter and New England Area Health Service
- Institute of Strata Title Management
- Local Government and Shires Association of NSW
- Landcom
- Lannock Strata Finance
- Macquarie Bank
- Main Library, UNSW
- Major Cities Unit, Department of Infrastructure and Transport, Australian Government
- National Heart Foundation
- NSW Department of Health
- NSW Department of Planning
- NSW Land and Property Management Authority
- NSW Office of Fair Trading
- NSW Transport and Infrastructure
- Owners Corporation Network
- Planning Institute of Australia
- Premier’s Council for Active Living
- SCOPE ACCESS
- Sydney South West Area Health Service (former)
- The Council of Social Service of New South Wales (NCOSS)
- The Independent Living Centre of NSW
- The Home Modification and Maintenance State Council
- The Physical Disability Council of NSW Inc (PDCN)
- The Productivity Commission
- Willana Associates

.....

3

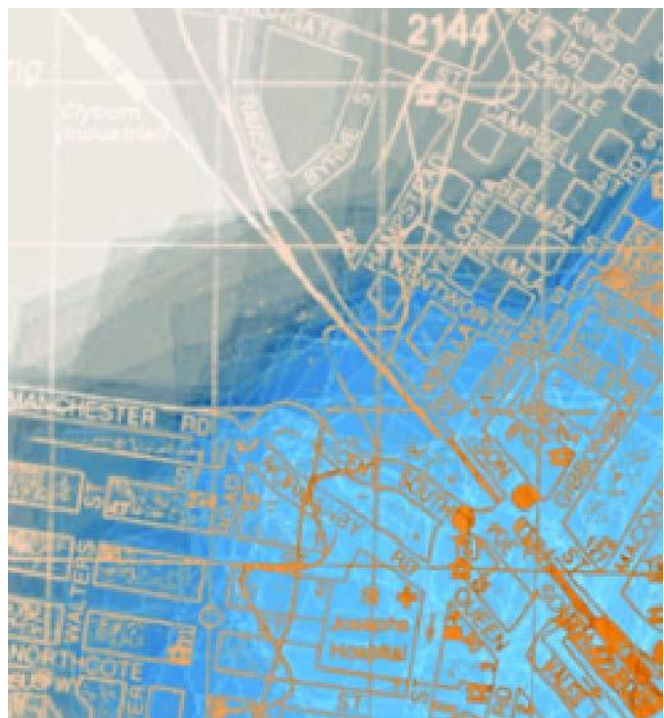

PERFORMANCE AGAINST TARGETS

3

PERFORMANCE AGAINST TARGETS

The following table sets out the Centre's performance against financial and other performance targets that were considered achievable under projected staffing and capacity.

	2010 Target	2010 Actual
	\$	\$
External Research income	1,000,000	1,974,463
Performance Targets		
Total projects completed in year	8	12
No. of publications eligible for DEST	35	41
No. of industry partner based projects	6	11
No. of media references/mentions	40	61
No of Australasian conference presentations	30	24
No of International conference presentations	5	10
No. of community/practice presentations	15	24
Post-graduate students (actual)	16	25
PhD completions (cumulative)	1	3
Masters by Research completions (cumulative)	1	0
Associate Faculty staff	10	9

The Centre's performance over the past five years is shown in the following table:

	2006	2007	2008	2009	2010
External Research income	\$0.708m	\$0.658m	\$1.197m	\$1.282m	\$1.974m
Non-Financial Targets					
Total projects completed in year	6	6	14	8	12
No. of publications eligible for DEST	5	16	18	30	41
No. of industry partner based projects	6	7	6	11	11
No. of media references/mentions	35	44	52	36	61
No of Australasian conference presentations	5	25	11	20	24
No of International conference presentations	5	2	7	6	10
No. of community/practice presentations	12	17	31	31	24



Post-graduate students (actual)	6	10	16	16	25
Post-graduate completions (cumulative)	0	0	0	1	4
Associate Faculty staff	11	9	7	6	9

4

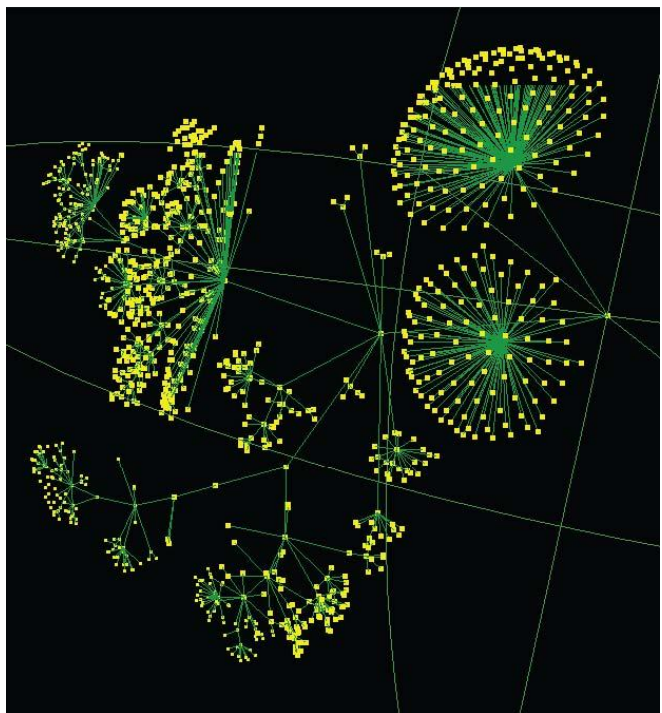

CITY FUTURES WEBSITE

4

CITY FUTURES WEBSITE

Visits and page views to City Futures Research Centre's website are monitored through *Google Analytics*.

Healthy Built Environments Program's website is part of the City Futures site and the number of unique visitors and page views are included in City Futures figures in the table below.

Number of visitors to www.cityfutures.net.au in 2010.		
	Page views	Unique visitors
January	3,628	1,003
February	4,935	1,169
March	6,586	1,710
April	4,657	1,350
May	6,262	1,985
June	4,386	1,520
July	4,686	1,418
August	6,192	1,901
September	5,586	1,811
October	4,822	1,598
November	3,659	1,277
December	3,857	1,138
Average	4,938	1,490

17,880 visits came from 103 countries/territories:

Country	Visits
Australia	14,758
United States	462
United Kingdom	347
New Zealand	249
China	230
Canada	191
Iran	160
Japan	105
Mexico	96
Germany	87

The most frequently viewed project web pages were:

ARC LP989373 – Governing the Compact City: The Role and Effectiveness of
(www.fbe.unsw.edu.au/cf/research/cityfuturesprojects/governingthecomcompactcity/)

- 1,878 Page views
- 1,354 Unique views

ARC LP100100804 - Planning and Building Healthy Communities:
A multidisciplinary longitudinal study of the relationship
between the built environment and human health
(www.fbe.unsw.edu.au/cf/research/cityfuturesprojects/healthycommunities/)

- 334 Page views
- 248 Unique view

ARC DP0773388 – The Demand for Higher Density Housing in Sydney and
Melbourne
(www.fbe.unsw.edu.au/cf/research/cityfuturesprojects/higherdensity/)

- 318 Page views
- 238 Unique Views

Managing Major Repairs in the Residential Strata Sector
(Research project funded by NSW Office of Fair Trading)
(www.fbe.unsw.edu.au/cf/research/cityfuturesprojects/managingmajorrepairs/)

- 103 Page views
- 77 Unique Views

ARC LP0776642 - Integrated Information Model to Support Metropolitan Planning,
Management and Analysis

(www.fbe.unsw.edu.au/cf/research/cityfuturesprojects/urbanit/)

- 103 Page views
- 71 Unique Views

HEALTHY BUILT ENVIRONMENTS PROGRAM

(<http://www.fbe.unsw.edu.au/cf/HBEP/>)

- 1,770 Page views
- 1,462 Unique Views

Four of City Futures Research Centre's AHURI Project Research Reports were listed on AHURI's top 20 most downloaded report list in 2010

(downloaded from <http://www.ahuri.edu.au>)

Report	Downloads
Positioning Paper: No. 127: Regulatory frameworks and their utility for the not-for-profit housing sector	306
Final Report: No. 144: Dwelling, land and neighbourhood use by older home owners	294
Positioning Paper: No. 134: Age-specific housing for low to moderate-income older people	204
Research Paper: International measures to channel investment towards affordable rental housing	204

HOME MODIFICATION INFORMATION CLEARINGHOUSE'S WEBSITE

Home Modification Information Clearinghouse maintains a separate external website for their Research Program: www.homemods.info/

The Program is required as part of its funding agreement with the Home and Community Care program contract to deliver an online information service.

Number of visitors to www.homemods.info/ in 2010.		
	Page views	Unique visitors
January	13,336	4,960
February	12,818	4,709
March	13,113	5,250
April	11,347	3,685
May	10,686	3,593
June	14,190	3,687
July	12,167	3,406
August	14,212	3,248
September	10,253	2,626
October	10,197	2,698
November	9,530	2,592
December	7,365	1,918
Average	11,601	3,531

42,372 visits came from 152 countries/territories:

Country	Visits
Australia	26,525
United States	12691
United Kingdom	1615
Canada	657
India	512
New Zealand	333
Singapore	304
Taiwan	200
Ireland	183
Philippines	174

Top 5 Publications Downloaded:

Title & link	No of Visits
Consumer Factsheet: - Arranging Home Modifications http://www.homemods.info/resource/evidence/consumer_factsheet_arranging_home_modifications_new_south_wales	2,766
Dementia Design Guidelines: Home and Community Care Capital Works Program (2nd Edition) http://www.homemods.info/resource/occasional/dementia_design_guidelines_home_and_community_care_capital_works_program_2nd_edition	2,624
Home Smoke Alarms: Hard Wired and Battery-Powered Systems - SUMMARY BULLETIN http://www.homemods.info/resource/occasional/home_smoke_alarms_hard_wired_and_battery_powered_systems_summary_bulletin	2,637
Industry Checklist: Designing home environments for people with problems with cognition who display aggressive or self-injurious http://www.homemods.info/resource/evidence/industry_checklist_designing_home_environments_for_people_with_problems_with_cognition_who_display_aggressive	2,143
Gardening at Home: Summary Bulletin http://www.homemods.info/resource/occasional/home_smoke_alarms_hard_wired_and_battery_powered_systems_summary_bulletin	1,938

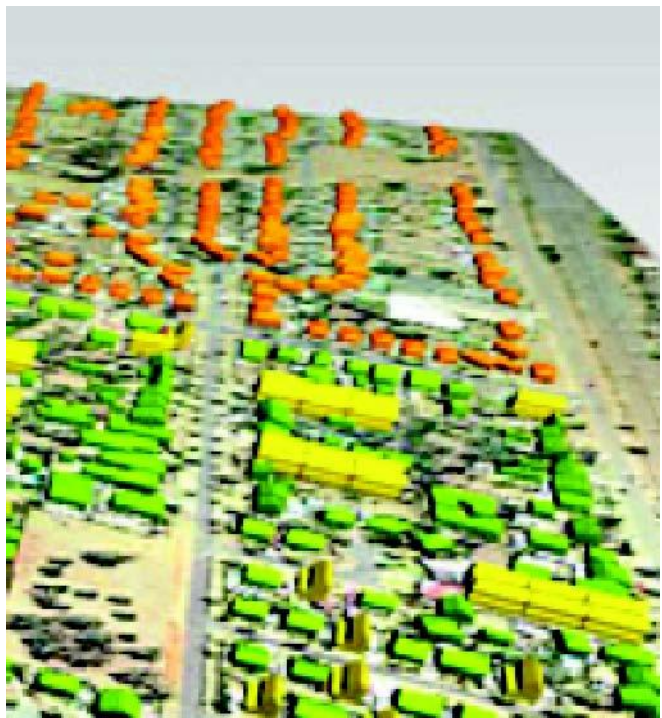

5

DESCRIPTION OF RESEARCH PROJECTS IN PROGRESS OR COMPLETED IN 2010

5

DESCRIPTION OF RESEARCH PROJECTS IN PROGRESS OR COMPLETED IN 2010

CITY FUTURES - PROJECTS COMPLETED DURING 2010

Project Name	Funded by	Start	Total Funds
ARC LP0668205: Assessing the Effectiveness of Public Housing Estate Regeneration in NSW	ARC	2005	\$ 441,782
ARC LP0776642: An Integrated Information Model to Support Metropolitan Planning	ARC	2006	\$627,000
AHURI Project 70392: The Efficient Use of Dwellings and Land by Older Homeowners	AHURI	2007	\$ 209,102
AHURI Project 30439: Institutional investment in affordable rental housing	Government of Western Australia	2009	\$ 4,828
Thermal Impact of the Designed Environment on the Urban Heat Island Funded by: Hassell (Sydney)	Hassell (Sydney)	2010	\$10,000
Living Well in Greater Density	Shelter NSW	2010	\$10,000

ARC LP0668205: Assessing the Effectiveness of Public Housing Estate regeneration in NSW

This project aims to develop and implement a framework for the evaluation of the Urban Renewal programs currently being developed by Housing NSW for its housing estates. The project is jointly funded by the Department and the Australian Research Council (ARC). The project commenced in 2006 and due for completion at the end of 2010 at the completion of the two APA(I) PhDs associated with the research.

While the framework is concerned to monitor the outcomes of renewal within estates, a particular focus of the evaluation methodology will be in understanding the impacts of urban renewal programs on the neighborhoods surrounding the renewal areas. An additional concern is to monitor the effect that public housing investment in an area might stimulate complementary private sector investment. This will entail addressing the issue of how the social cost/benefit outcomes of renewal programs can be effectively measured and addressed.

In 2009, extensive testing of the methodology was undertaken involving the completion of over 1000 questionnaires amongst both public and private housing residents in two suburbs of Sydney. The findings of this survey led to preparation of two community baseline reports for HNSW.

For more information regarding this project, please visit the project website:

www.fbe.unsw.edu.au/cf/research/cityfuturesprojects/urbanimprovement/

ARC LP0776642: An Integrated Information Model to Support Metropolitan Planning

The UrbanIT project at UNSW has completed a 2-year research and development project funded by the Australian Research Council in partnership with City of Sydney, NSW Department of Planning and Landcom. The project has progressed existing and emerging technologies with the aim of helping better inform urban planning by focussing on the sensitive point where an individual building interfaces with its urban context. The framework extends three key areas to form the foundation of a spatial decision support system for integrated planning:

- **Building Information Modelling** – The UrbanIT framework has extended this technology that traditionally models single sites, to accommodate clusters of buildings.
- **Geographic Information Systems** – The UrbanIT framework demonstrates the capacity for these systems to provide access to a finer grain of urban knowledge by bringing together intelligence from distributed geospatial data sources, presenting them online and in three-dimensions.
- **Information Integration by Ontology** – Using semantic-web techniques, this approach helps unify information and deliver meaningful (semantic) intelligence to decision makers.

An range of applications are now possible, spanning from detailed building analysis and contextual compliance checking, through to urban-scale and multi-stakeholder decision support systems critical for managing the development of our city into the future.

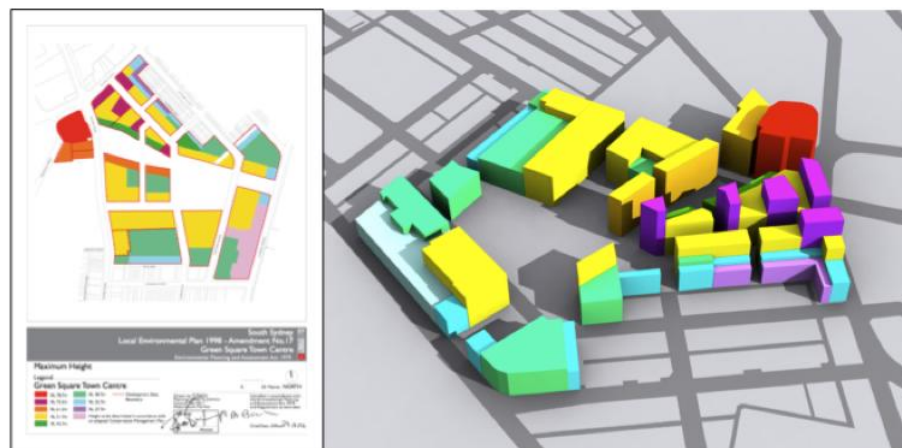

For more information regarding this project, please visit the project website:

<http://www.fbe.unsw.edu.au/cf/research/cityfuturesprojects/urbanit/>

AHURI Project 70392: The Efficient Use of Dwellings and Land by Older Homeowners

Funded by AHURI and the Commonwealth Department of Health and Ageing, this project examined how older home-owners utilise the space in their dwellings, land and neighbourhood, and the barriers in housing and neighbourhood design to ageing in place. A mixed method approach included analysis of ABS Data, a national survey of 1604 older home owners, 70 in-depth interviews and the cost-benefit analysis, and a . cost-benefit analysis of inclusive housing design approaches for older people (Visitable, Adaptable and Universal Design) compared to conventional home modification.

The study found that while the vast majority of older people in Australia lived in owner-occupied separate houses of 3 or more bedrooms, often regarded as highly

underutilised, most were satisfied with the size of their homes and utilised 'spare' bedroom space for a range of activities important to their health and wellbeing. When considering options for improving efficiency and liveability, older home owners overwhelmingly favoured remaining in their home with supporting professional care services rather than moving to a more suitable home, age specific accommodation, or sharing with relatives. The cost-benefit analysis found that only Visitable Design had a positive cost-benefit ratio, that Universal Design was superior to Adaptable Design, and that conventional home modification was by far the least viable.

For more information regarding this project, please visit the project website:
www.fbe.unsw.edu.au/cf/research/ahuriprojects/theefficienseofdwelling/

AHURI Project 30439: Institutional Investments in Affordable Rental Housing

This project aims to inform the development of policies, institutions and instruments that promote adequate and secure levels of low-cost finance towards well regulated affordable housing providers which will enable them to increase the supply of affordable housing. The main approach is to examine in detail financial approaches in Europe and North America with a view to informing the policy debate in Australia. Sponsored by the Government of Western Australia, and coordinated by AHURI, the project was awarded to a team of housing researchers at City Futures and RMIT University in October 2009.

This project has two stages:

- The identification and analysis of key institutional mechanisms for attracting institutional investment towards affordable rental housing in the Netherlands, France, UK, Switzerland, Austria and the US. Data was gathered. A report was submitted to the Government of Western Australia early in December 2009, and has now been agreed.
- Detailed illustrative case studies of two successful models: the Austrian Housing Banks and Housing Construction Convertible bonds, and the use of private finance and bonds issued by the Housing Finance Corporation in the UK. Two reports were submitted in late December 2009.

It is anticipated that the three reports will be published by AHURI in due course, and there is a possibility the Government of Western Australia will consider an additional stage to the project to consider practical issues for Australia.

Thermal Impact of the Designed Environment on the Urban Heat Island

Funded by: Hassell (Sydney)

A pilot research program evaluating the thermal emissivity of elements in the designed environment and their transience to the urban air was carried out in the summer of 2010 in the Victoria Park medium-density residential precinct of Sydney. At question is the degree to which components of the built environment and associated urban landscapes contribute waste heat to the urban climate and heat island. The intention is to contribute knowledge of thermal performance at a micro-urban scale - to design decisions aimed at adaptively counteracting global and urban warming phenomena, and mitigating noxious consequences by cooling urban environments.

The results have been tabulated in a Thermal Performance Index in the Final Report available at the link below:

<http://www.fbe.unsw.edu.au/cf/research/cityfuturesprojects/heatiland/>



Living Well in Greater Density

Funded by: Shelter NSW

Higher density housing has been a cornerstone of the NSW state governments' metropolitan plans since the 1980s. An increase in medium and high density housing has been seen as a necessary response to pressures of a rapidly increasing population and concerns associated with the environmental and infrastructure costs associated with suburban sprawl.

While the pros and cons of urban consolidation have been debated extensively from a 'big picture' planning perspective, less attention has been given to the lived experiences of the residents of higher density dwellings.

The project outlines some of the most common challenges faced by residents in higher density developments, including (but not limited to) noise, neighbour disputes, privacy and limited open space. The research considered issues facing all higher density households, including low income and vulnerable households.

The project includes an analysis of media coverage in this area in NSW as well as a comprehensive review of the international literature on challenges faced by residents of higher density dwellings. These issues were discussed at a roundtable discussion in Sydney with representatives from residents groups and other stakeholders. Input from this discussion is included in the final report.

The report provides an evidence base that can be used to develop and promote solutions to the challenges identified, in order to ensure better housing outcomes for residents in higher density developments in NSW.

For more information regarding this project, please visit the project website:

<http://www.fbe.unsw.edu.au/cf/research/cityfuturesprojects/shelter/>

CITY FUTURES - PROJECTS ONGOING AT END OF 2010

Project Name	Funded by	Start	Total Funds
ARC DP0986122: The Drivers and Outcomes of Re-Investments in Low Density Suburban Housing Markets	ARC	2009	\$ 273,000
ARC LP0989373: Governing the Compact City	ARC	2010	\$266,000
ARC LP0990075: Implementing Metro Planning Strategies	ARC	2010	\$296,000
AHURI Project 70569: Service integration and indigenous housing	AHURI	2009	\$177,760
AHURI Project 40559: Regulatory Frameworks and Their Utility for the Not for Profit Housing Sector	AHURI	2009	\$32,559
AHURI Project 50565: Secure Occupancy in Rental Housing: A Comparative Analysis	AHURI	2009	\$48,909
AHURI Project 70588: Partnership working in the design and delivery of housing	AHURI	2009	\$72,705
AHURI Project 70615: Pathways and choice in a diversifying social and affordable housing system	AHURI	2010	\$127,298
AHURI Project 70617: How sustainable are Australia's contemporary affordable housing projects?	AHURI	2010	\$116,430
AHURI Project 70639: Community Land Trusts and Indigenous Housing Outcomes System	AHURI	2010	\$22,061
National Climate Change Adaptation Research Facility	Department of Climate Change	2009	\$144,000

ARC DP0986122: The Drivers and Outcomes of Re-Investments in Low Density Suburban Housing Markets

This two-year research project, commenced in July 2009, explores the process of reinvestment in lower density housing which has become a significant factor in the incremental renewal of these areas with implications for their socio-economic stability as well as their adaptation to improved environmental standards. Using both quantitative and qualitative research methods and Sydney as an exemplar, the project studies the rate and scale of renewal and the drivers of this process from both the supply and demand side of the market.

The study is based primarily on analysis of Development Applications at local councils and census data, to assess the magnitude and the geography of knockdown-rebuild and major renovations activity in Sydney, and its correlation with various socio-economic and land value factors. In addition, a survey to over 7000 properties in which knockdown-rebuild has taken place in the last 5 years, and over 80 in-depth face-to-face interviews with residents, planners and builders in the knockdown-rebuild industry will provide a deeper understanding of the

drivers of demand and supply for this activity, as well as its environmental and social impacts.

For more information regarding this project, please visit the project website:

www.fbe.unsw.edu.au/cf/research/cityfuturesprojects/knockdownrebuild/



ARC LP0989373: Governing the Compact City

Strata is the fastest growing form of residential property ownership in Australia. Over half the new dwellings to be built in our metropolitan areas over the next decades will be strata titled. The growth of this sector raises increasingly important questions over property ownership and governance.

This two-year research project, supported by the NSW strata industry and the NSW State and Federal governments, is charting the key issues facing the governance and management of strata buildings. The research is being undertaken by the High Density City team at the City Futures Research Centre. The project is the first major study of the strata sector undertaken in Australia.

The research has three main aims: to explore the role, capacity and effectiveness of owners' corporations as agencies of property governance and management; to explore the capacity and effectiveness of strata managers; and to assess how well residential strata works from strata owners' points of view.



The project, which focuses on NSW, will deliver systematic information about the operation of the strata system. The findings will assist residents, owners and those involved in strata management and policy development to better understand the nature and scale of issues facing the strata sector and its capacity to self-manage these issues. It will provide an informed evidence base to support improved best practice and policy development across the sector. While it focuses on NSW, the results will inform policy and practice in the strata sector across Australia.

The research is being undertaken by the City Futures Research Centre in partnership with the Institute of Strata Title Management, the Owners Corporation Network, Lannock Strata Finance, Macquarie Bank, NSW Land and Property Management Authority, and NSW Fair Trading. The contract for this project was signed in December 2009, and work on the project commenced in January 2010.

For more information regarding this project, please visit the project website:

www.fbe.unsw.edu.au/cf/research/cityfuturesprojects/governingthecomcompactcity/



ARC LP0990075: Implementing Metro Planning Strategies

The project is a three-year research programme working with the NSW Department of Planning (DOP) and state development agency Landcom. The overarching aim of the project is to develop a suite of practically applicable methods to enable the partner agencies to assess local housing demand profiles. Supply-side issues and mechanisms are well understood and monitored. Forecasting techniques, and assumptions based upon these techniques, are used to ‘plan’ our cities into the future. However, the actual translation of these strategies requires a more nuanced and pragmatic approach if the differential geographies of housing demand – and the different drivers and components of demand – are to be understood and worked with.

The project commenced in January 2010 with the initial stages of the research incorporating a synthesis of existing research that the partners had commissioned in the previous 5 years. The synthesis was a necessary stage of the linkage for two core reasons; the first was to articulate the supply side language of the existing materials with a more explicit emphasis on the role of local demand, the second was to introduce some of the key concepts behind the chosen methodological approaches to be taken forward in the next stages of the research. These methodological approaches are being developed by the project’s APA(I) PhD

candidate and focus on the profiling of local submarket functionality with an explicit emphasis on patterns of inter and intra regional migration.

For more information regarding this project, please visit the project website:

www.fbe.unsw.edu.au/cf/research/cityfuturesprojects/metroplanning/

AHURI Project 70569: Service Integration and Indigenous Housing

This AHURI-funded research is investigating how social housing services are provided to Indigenous clients in urban and regional settings. The primary aim is to better understand how to deliver these services in ways that will be consistent with cultural values and lead to better outcomes for Indigenous housing applicants and tenants. A key theme concerns the respective roles of mainstream and culturally specific housing services and how effectively these are integrated across the service system.

The project is being undertaken collaboratively by the UNSW/UWS AHURI Research Centre and the AHURI Queensland Research Centre, University of Queensland. Chief investigator for the project is Associate Professor Vivienne Milligan. Expert advice and support for the conduct of the research is being provided by Indigenous researchers at both institutions.

Stage 1 of the study, which involved a review of housing policies and services and relevant academic literature, a workshop with Indigenous service providers and a review of urban Indigenous housing in Canada has been completed and a positioning paper was published in June 2010. Stage 2 has involved in-depth case studies of the service delivery environment in three urbanised locations, one each in New South Wales, Queensland and Victoria. Overall, the study aims to critically examine current barriers to achieving good housing outcomes for Indigenous clients in the social housing delivery system and to offer policy makers and service providers the latest evidence about appropriate service delivery for Indigenous clients. The field research for this project is completed and a final report will be published later in 2011.

For more information regarding this project, please visit AHURI's project website:

<http://www.ahuri.edu.au/publications/projects/p70569>

AHURI Project 40559: Regulatory Frameworks and Their Utility for the Not for Profit Housing Sector

This project which investigated the usefulness of regulatory frameworks for the 'not for profit' housing sector in Australia was completed during the year and the final report was published in January 2011. The project was led by researchers at the University of Tasmania in collaboration with the UNSW/UWS AHURI Research Centre at City Futures and the AHURI Queensland Research Centre, University of Queensland. It reviewed the potential advantages and disadvantages of regulation of housing not for profit organisations in the light of regulatory theory, stakeholder views and international experience. City Futures team members were responsible for conducting field work in NSW and contributing to the project's publications. Two reports of the project are available at:

<http://www.ahuri.edu.au/publications/projects/p40559>

AHURI Project 50565: Secure Occupancy in Rental Housing: A Comparative Analysis

This AHURI-funded research addresses a key concern for Australian policy makers: how to enable households who rent, in particular, lower income and vulnerable households, to have secure occupancy to enable them to raise their

families and participate in economic and social life. The key focus is how security of occupancy is provided, and what improvements could be made, especially for lower income and vulnerable households who may rent for long periods.

The project is being led by Associate Professor Kath Hulse at Swinburne University, working in collaboration with researchers, Vivienne Milligan and Hazel Easthope, at the UNSW/UWS AHURI Research Centre UNSW.

The study uses a comparative research method to identify and compare the diversity of approaches to this issue across a variety of countries. International experts in eight advanced countries have been engaged to provide country reports, using a standard template, on the legislative, policy and program frameworks for providing secure occupancy for households across their rental sectors. Two local studies, in NSW and Victoria, have also been conducted. The field research for this project is completed and a final report will be published in 2011.

For more information regarding this project, please visit AHURI's project website:

www.ahuri.edu.au/publications/projects/p50565

AHURI Project 70588: Partnership working in the design and delivery of housing policy and programs

This project examines opportunities and challenges for partnership approaches in the context of housing and urban policy. The research draws upon interviews with over 40 experts, practitioners and policy-makers who have detailed insight into partnership working practices, from a wide range of perspectives. A particular focus has been on partnership working in urban renewal projects and development of affordable housing. Key themes addressed in the study are: First, the impact of place and community in shaping the scope and nature of partnership working; Second, the complexity of housing (and particularly mixed-tenure housing) as an asset class; Third, the challenge of balancing certainty with flexibility in structured arrangements given the changing policy and housing market contexts within which partnerships operate; and, fourth, the risks associated with increased interdependencies between public, private and not-for-profit sectors.

The project's final report is available online:

<http://www.ahuri.edu.au/publications/projects/p70588>

AHURI Project 70615: Pathways and Choice in a Diversifying Social and Affordable Housing System

This study seeks to provide a better understanding of how access to social housing and mobility within the Australian social housing system are experienced by tenants, in a time of significant changes to the sector. Decentralisation and the growing diversity of the social and affordable housing system, with a panoply of administering bodies and various regimes of allocation, provide important opportunities to increase housing choice for low-income households, while also raising new challenges. The specific research questions for this project are: What are the pathways of entry into and mobility within the social/affordable housing system? What potential advantages are there in a diversifying social housing system for social housing tenants? Is there any evidence of some groups being more disadvantaged? If so, why? The research consists of a desk-based review of social and affordable housing allocation policies, as well as surveys and over 80 interviews with tenants and housing administrators in NSW, Victoria and Queensland.

The positioning paper for this project is available online at:

<http://www.fbe.unsw.edu.au/cf/research/ahuriprojects/pathways/>



AHURI Project 70617: How Sustainable are Australia's Contemporary Affordable Housing Projects?

This study offers new ways to conceptualise and measure the sustainability of affordable housing projects in Australia and their financial, environmental and social outcomes. This is the first Australian study to address expectations to achieve sustainability in all three domains, where some trade-offs appear inevitable. Unlike earlier work, the lens of analysis in the current study is at project level. This fills a gap in the Australian literature by analysing the detailed finances and sustainability outcomes of recent projects. Research of this type will be of practical benefit to affordable housing providers who can learn from best practice. In addition, policy makers will be able to contrast financial, environmental and social sustainability outcomes achieved with different forms and levels of public support. The study uses mixed research methods including data collection via templates, semistructured interviews with executive staff and stakeholders of nonprofit developers, expert assessment and tenant focus groups. Eight recent affordable housing projects have been selected as case studies in three jurisdictions (Queensland, NSW and Victoria). The selection of projects allows contrasts to be drawn across organisational and project types, and between different public sector approaches to sustainability.

For further information, please visit:

http://www.fbe.unsw.edu.au/cf/research/ahuriprojects/how_sustainable/

AHURI Project 70639: Community Land Trusts and Indigenous Housing Outcomes System

Community Land Trusts (CLTs) are a model of community-based, perpetually affordable housing that has been operating in the United States for the past 30 years and more recently in the United Kingdom. CLTs are a mechanism for creating affordable home ownership that remains affordable across re-sales and inheritance, and establishes clear and ongoing relationships between homeowners and their community.

This research project is investigating the potential of CLT models to enhance tenure choices for Indigenous households in Australia, in the context of government aims to offer a way of providing home ownership that is both affordable and consistent with Indigenous aspirations. The project, which will be guided by ongoing input from Indigenous stakeholders, will involve examination of international evidence of use of CLTs and it will attempt to establish a replicable consultative methodology for assessing the feasibility and application of the model

in a variety of local situations in urban, regional and remote areas of NSW and Queensland.

The research is being led by Dr Louise Crabtree at the University of Western Sydney working in collaboration with Professor Peter Phibbs (UWS) and Associate Professor Vivienne Milligan at City Futures, UNSW. The project commenced in October 2010 and will be completed in 2011/12.

For more information regarding this project, please visit AHURI's project website <http://www.ahuri.edu.au/search.asp?sitekeywords=70639&CurrentPage=1>

The Australian Climate Change Adaptation Research Network for Settlements and Infrastructure

Funded by: National Climate Change Adaptation Research Facility

In 2008 the Australian Government committed funding of \$10 million over four years to establish eight national research networks investigating the effects of climate change on areas such as water resources and freshwater biodiversity; primary industries; terrestrial biodiversity; human health; emergency management; settlements and infrastructure; marine biodiversity and resources; social, economic and institutional dimensions.

The Australian Climate Change Adaptation Research Network for Settlements and Infrastructure is based in the School of Civil and Environmental Engineering, part of the National Climate Change Adaptation Research Facility hosted by Griffith University. The aim is to lead the research community in a national interdisciplinary effort to generate the information needed by decision-makers in government and in vulnerable sectors and communities to manage the risks of climate change impacts and choose appropriate adaptation strategies.

Prof Bill Randolph co-lead the bid that brought the Network for Settlements and Infrastructure to UNSW in 2008. The Centre hosts the Built Environment Node of the Network and during 2009 Dr Peter Graham took over the leadership of this Node from Prof Randolph. The Built Environment Node focuses on the impacts of climate change on building and facility design and construction to explore the social, economic and institutional implications of climate change impacts, and the resulting implications for planning, design and management of Australian settlements and infrastructure.

The aim is to make research into climate change adaptation in both the physical and human aspects of Australia's settlements and infrastructure a truly multi-disciplinary enterprise. In this way, the Network will build our understanding and national adaptive capacity and reduce our vulnerability to climate change in key sections and regions of the country.

The NCCARF initiative funds a half time appointment to support the activities of the Node. The Centre successfully bid for matching funding from the FBE. We are currently seeking to fill the Research Associate position vacated by Dr Peter Rickwood.

More information is at:

http://www.civeng.unsw.edu.au/research/research_centres_and_laboratories/australian_climate_change_adaptation_research_network_for_settlements_and_infrastructure_accarnsi/index.html

HEALTHY BUILT ENVIRONMENTS PROGRAM - PROJECTS COMPLETED DURING 2010

Project Name	Funded by	Start	Total Funds
Healthy Built Environments: A Cross-disciplinary Course for Post Graduates in Built Environment and Health	FBE Learning and Teaching Action Research Grants	2010	\$2,000



Healthy Built Environments: A Cross-disciplinary Course for Post Graduates in Built Environment and Health

FBE Learning and Teaching Action Research Grants

The aim of this project was to develop a comprehensive curriculum (course content and teaching methodologies) for a cross-disciplinary post graduate course in healthy built environments. The resulting course is specifically targeted towards students (who may also be professionals in the work force) undertaking post graduate degrees in the built environment and health. The intersection of these two disciplines is a rapidly emerging area of practice and research. This has grown out of global concerns about the rise of serious chronic disease (adversely affecting both physical and mental health) and the inability of the health system (ie medical treatment, drug therapies and surgical interventions) to address these issues. Together with ever escalating health budgets, governments are now looking to prevention as a much better way to address these problems. Such an approach is well beyond the health system and demands the collaborative contribution of built environment professionals to consider how physical and socio-cultural environments impact on human physical and mental health. This project utilised current research and best practice examples to devise the course curriculum. Teaching methodologies were explored taking into account the needs of post graduate students. On-line learning components were investigated, as were practical exercises that facilitate cross-disciplinary student learning.

HEALTHY BUILT ENVIRONMENTS PROGRAM - PROJECTS ONGOING AT END OF 2010

Project Name	Funded by	Start	Total Funds
ARC LP100100804: Planning and Building Healthy Communities: A multidisciplinary longitudinal study of the relationship between the built environment and human health	ARC	2011 (Awarded 2010)	\$354,897
Healthy Built Environments Program (core funding)	NSW Health	2009	\$1,500,000
AHURI 70619: The Impacts of Housing on Health	AHURI	2010	\$42,080

ARC LP100100804: Planning and Building Healthy Communities: A multidisciplinary longitudinal study of the relationship between the built environment and human health

This project examines how urban environments support health. Tracking residents' behaviours over a long time, the study fills a gap in current knowledge about how urban environments manage and promote good health (a national research priority area). It will identify the design features, social interventions and locational qualities in selected sites which positively benefit human health. The research will describe the likely health outcomes for future Australians living in areas with similar characteristics. It will also strengthen multidisciplinary approaches and policy development in this area by bringing together a team from urban planning, development and health.



Healthy Built Environments Program

Funded by NSW Health

The Healthy Built Environments Program is an innovative collaboration that brings the built environment and health together. The Program is situated in the City Futures Research Centre and receives its core funding from the NSW Department of Health. Increasingly the health sector is focusing on prevention and to be effective, health professionals need to work in collaboration with other professional groups, especially those from the built environment. The Healthy Built Environments Program is contributing to revitalising the relationship between the built environment and health professions. The Program's vision is that built environments will be planned, designed, developed and managed to promote and protect health for all people.

AHURI 70619: The Impacts of Housing on Health

There is growing national and international interest on the link between the built environment and health, including a concern that western societies have constructed urban environments fundamentally unhealthy for their inhabitants. It is necessary to mark out the housing part of this built environment area by undertaking robust research that investigates the link between housing and health. However, this is such a large area of research it is considered essential that a scoping study be undertaken to identify the current level of knowledge and major research gaps, prioritize these, and design a small number of research projects to explore the highest priority research gaps. This study uses an Investigative Panel comprising leading researchers, public health and housing policy officials from across Australasia and New Zealand to do this.

HOME MODIFICATION INFORMATION CLEARINGHOUSE'S - PROJECTS COMPLETED DURING 2010

Project Name	Funded by	Start	Total Funds
Liveable Communities photographic resource project	Local Government and Shires Association of NSW	2010	\$5,750
Sustaining 'Aging in Place': Towards a multidimensional analysis of informal care within the Asia-Pacific region	Tokyo University	2008	\$12,659
AHURI 60512: Reverse mortgages and older people	AHURI	2008	\$92,860
AHURI 70636: Older Peoples Housing Policy	AHURI	2010	\$24,279
AHURI 70589: Age-Specific housing markets	AHURI	2008	\$189,162

Liveable Communities photographic resource project

Funded by: Local Government and Shires Association of NSW

This project was the development of a local and relevant Photographic Database that could be used, among other things, to educate the community about what

makes a local area “liveable” from the perspective of older people and people with a disability. It set about obtaining a photographic collection of examples of parts of the built environment that were the responsibility of a council (i.e. accessible to all people and are publicly owned or managed) and also areas such as commercial areas, parks, banks etc that people are free to access. The WHO Aged Friendly Environments checklist was used as a tool for selecting photographs for this digital repository. The images highlight good design and innovative solutions to environments that are pleasant, safe and accessible to people of all ages and abilities.



Sustaining ‘Aging in Place’: Towards a multidimensional analysis of informal care within the Asia-Pacific region

Funded by: Tokyo University

This project analysed the informal care options for people in six Asia-Pacific countries (China, Japan, New Zealand, Nepal, Australia and Malaysia) from a policy makers and/or legislators perspective.

Changes in family structure, migration of younger people to urban centres and the steady growth of females living alone make the creation and maintenance of a stable informal care system a challenge across the entire Asia-Pacific region.

While the challenges were acknowledged, opportunities were identified for the sharing of resources and research and for networking. Prevention strategies, active ageing and age friendly policies were identified as critical elements in both managing the quality of life for older people and the informal burden of care.

AHURI 60512: Reverse mortgages and older people

The research findings so far confirmed the large untapped potential of reverse mortgage products to assist in maintaining both our housing capital and in enabling ‘ageing in place’ by providing greater personal control and flexibility to deal with economic adversity. However, they underscore the complexity of the market and the current regulatory situation. Despite the many obstacles, reverse mortgages are an important means for low-income but ‘asset-rich’ older homeowners to ‘age in place’ with a reasonable standard of living.

Further, our literature review highlighted that consumer education and appropriate targeting are crucial. Reverse mortgages can work well if older consumers have carefully considered their specific circumstances and future needs, and if they are

fully aware of the terms and conditions of the contract and any potential traps. Thus financial literacy and good impartial advice is crucial, as compound interest and contract default clauses are often poorly understood by older people. It also appears that those older people likely to benefit most are those on the lowest-incomes with an appreciating asset and who are in the last few years of their life.

AHURI 70636: Older Peoples Housing Policy

This project sought to pull together the current research knowledge needed to inform the development of a housing policy for an Ageing Australia. The project looked broadly at the existing Australian literature on ageing with emphasis in the interactions between housing policy and the pension and taxation systems, the role of age specific housing (as opposed to mainstream housing) and the impact of transitional events on older people's lives.

Specific issues include (but are not limited to) the areas of assets and income, housing assistance, home ownership, formal and informal care provision, health and wellbeing, social inclusion, housing design, housing modification, physical locale, and dwelling and neighbourhood quality.

The key theme is those structures within the housing systems including finance, support services and tenure arrangements that enable households to access housing as their needs change over time.



AHURI 70589: Age-Specific housing markets

This research project seeks to better understand the nature of the age-specific housing market in Australia and what drives or does not encourage older people to seek age specific accommodation.

Our research aims were as follows: to acquire knowledge and understanding of the nature of the age-specific housing market in Australia; how providers perceive the age-specific housing market and what they view as incentives and disincentives to invest therein and how older people perceive age specific housing; and what drives or does not encourage older people to seek age specific accommodation. Our

multi-method research design involved a literature review, a survey questionnaire and in-depth semi-structured interviews of residents, providers and key national and State policy players. The interviews and survey data provided detailed information requiring the needs and expectations of low-moderate income older persons and the age specific housing market.

HOME MODIFICATION INFORMATION CLEARINGHOUSE'S - PROJECTS ONGOING AT END OF 2010

Project Name	Funded by	Start	Total Funds
Home Modification Information Clearinghouse, University of New South Wales, Recurrent research annual funding	Local Government and Shires Association of NSW	2008	\$210,000
Home Modification Information Clearinghouse, University of New South Wales, Non-recurrent research funding	ADHC	2010	\$417,311

Home Modification Information Clearinghouse, University of New South Wales, Recurrent research annual funding

This project seeks to maintain the ongoing work of the HMICH by maintenance of the website, and of key research and administration positions. The objectives are to:

- Build information and knowledge capacity within the residential construction sector in order to improve standard home design and to provide evidence for the effectiveness of special features to better the living environments of aged and/or people with disabilities, and their carers.
- Integrate diverse knowledge and cross-disciplinary research.
- Develop a leading edge Home Modification Information Clearinghouse that will be accessible to the full range of industry and consumer target groups.
- Facilitate home and community care outcomes, focusing on home modification across NSW.
- Promote innovative housing models for older people and people with disabilities within the building and development industry.
- Develop Factsheets detailing best practice principles for assessment and the setting of priorities for the home modification services.
- Promote the benefits and products of home modification and adaptable housing to the broader community through mainstream media.
- Share information at International, National, State and Regional industry forums and liaise with peak regional providers and consumers.
- Ensure that there are effective links between home modification service providers and consumers.

Home Modification Information Clearinghouse, University of New South Wales, Non-recurrent research funding

This project covers the specific publications as defined by the funding agreement of that year.

- \$85,000 was allocated to investigate the evidence based practice deliverable “Investigating bridging and earth berming as a level access solution.”
- \$200,000 was allocated to “Research and develop approaches to post home modification follow up on the completion of minor modifications by allied health professional”.
- \$132, 311 was allocated to conduct a user appraisal of the contribution of environmental factors on the independence and well being of older people in three regional town centres. In consultation with ADHC this funding was leveraged to an ARC Linkage grant application submitted in November 2010 (outcome pending).

6

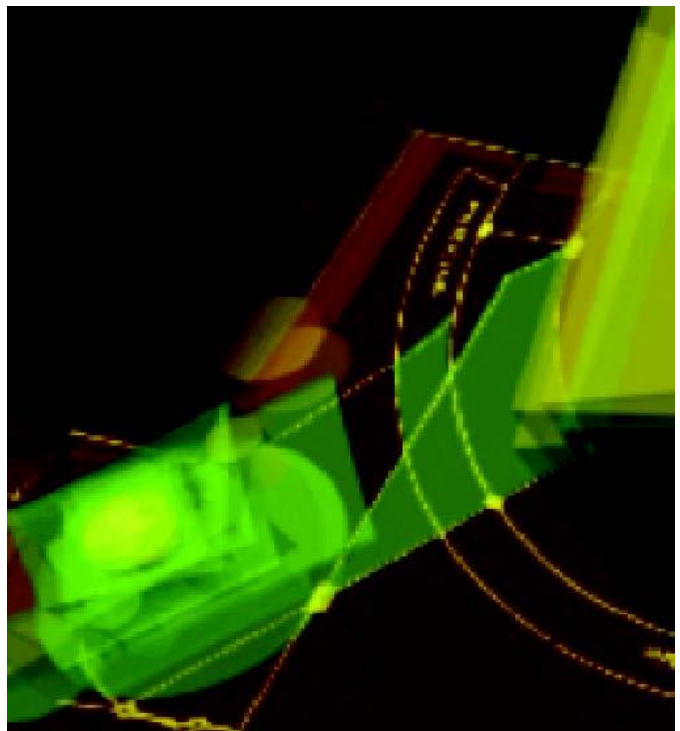

DISSEMINATION: PUBLICATIONS AND PRESENTATIONS

6

DISSEMINATION: PUBLICATIONS AND PRESENTATIONS

REFEREED PUBLICATIONS

BOOK CHAPTERS

Bridge, C.	'Home Adaptations and Modifications' (Chapter 28) In Curtin, M., Molineux, M. & J. Supyk (Eds.), <i>Occupational Therapy and Physical Dysfunction - Enabling Occupation</i> (6 th Ed.): Elsevier Press pp 409-429, 2010
Pinnegar, S., Freestone, R. & Randolph, B.	'Suburban Reinvestment through 'Knockdown Rebuild' in Sydney', in Mark Clapson, Ray Hutchison (ed.) <i>Suburbanization in Global Society</i> (Research in Urban Sociology, Vol 10), Emerald Group Publishing Limited, pp 205-229, 2010
Whybrow, S. Sharma, V., Gupta, S., Rahim, A. Millikan, L. & Bridge. C.	'Legislation Anthropometry and Education: The Southeast Asian Experience' , n E. Steinfeld & Maisel, J. (Eds). <i>Emerging Research and Strategies in Universal Design</i> . Universal Design State of the Science Publication. Bentham Books. New York.144-152, 2010

REFEREED JOURNAL ARTICLES

Bunker, R. & Ruming, K.	'Focus on ... The Elephant in the Room' , <i>Australian Planner</i> , Volume 47, No 1, pp 46 – 47, 2010
Bunker, R. & Ruming, K.	'How National Planning Might Enrich Metropolitan Planning in Australia' , <i>Urban Policy and Research</i> , Vol 28, No 3, pp 327-334, 2010
Bunker, R. & Searle, G.	'New Century Australian Spatial Planning: Recentralization under Labor' , <i>Planning Practice and Research</i> , Vol 24, No 4,, pp 517-529, 2010
Capon, AG and Thompson, SM	'Planning for the Health of People and Planet: An Australian Perspective' , <i>Planning Theory and Practice</i> , Vol 11, No 1, pp 109-113, 2010
Gilmour, T. and Pawson, H.	'Transforming Australia's Social Housing: Pointers from the British stock transfer Experience' , <i>Urban Policy and Research</i> , Vol 28, No 3, 241-260, 2010
Gilmour, T., Wiesel, I., Pinnegar, S & Loosemore, M.	'Social Infrastructure Partnerships: a Firm Rock in a Storm?' , <i>Journal of Financial Management of Property and Construction</i> , Vol 15, No 3, pp 247-259, 2010
Jung, Y-M.	'Ceiling Hoists as part of a sustainable care strategy: Evidence based research' , <i>Independent Living</i> , Vol 26, No 3, pp 24-25, October 2010
Milligan, V. & Pinnegar, S.	'The Comeback of National Housing Policy in Australia: First Reflections' , <i>European Journal of Housing Policy</i> , Vol 10, Issue 3, 325-344

Pawson, H. & Gilmour, T.	'Transforming Australia's Social Housing: Pointers from the British stock transfer Experience' , <i>Urban Policy and Research</i> , Vol 28, No 3, 241-260, 2010
Randolph, B., Ruming, K. & Murray, D.	'Unpacking Social Exclusion in Western Sydney: Exploring the Role of Place and Tenure' , <i>Geographical Research</i> , Volume 48, No 2, pp 197-214, 2010
Randolph, B., Woolcock, G. & Pinnegar, S.	'Urban Research and Child-Friendly Cities: a New Australian Outline' , <i>Children's Geographies</i> , Vol 8, No 2, pp 177-192, 2010
Ruming, K., Randolph, B., Pinnegar, S. & Judd, B.	'Urban Renewal and Regeneration in Sydney, Australia: Council Reflections on the Planning and Development Process' , <i>Journal of Urban Regeneration and Renewal</i> , Vol 3, No 4, pp 357-369, 2010
Ruming, K., Tice, A. & Freestone, R.	'Commonwealth Urban Policy in Australia: the Case of Inner Urban Regeneration in Sydney, 1973-75' , <i>Australian Geographer</i> , Vol 41, No 4, pp 447-467, 2010
Thompson, SM., Whitehead, A. & Capon, AG.	'The Healthy Built Environments Program: A joint initiative of the NSW Department of Health and the University of NSW' , <i>NSW Public Health Bull 2010</i> ; 21 (5-6): 134-8. doi: 10.1071/ NB10020
Wheeler, AR. & Thompson, SM.	'The Future Health and Environmental Sustainability of South East Queensland: an Evaluation of the Regional Plan' , <i>Australian Planner</i> , Vol 47, No 3, pp152-161, 2010
REFEREED REPORTS	
Bridge, C., Adams, T., Phibbs, P., Mathews, M. & Kendig, H.	'Reverse Mortgages and Older People: Growth Factors and Implications for Retirement Decisions' , AHURI Final Report no 146, May 2010
Bridge, C., Takahashi, E., Chalise, H., Kiata, L., Ono, M., Iwakuma, M., Qiao, N. Ibrahim, R. and Wada, T.	'Sustaining 'Aging in Place': Towards a Multidimensional Analysis of Informal Care within the Asia Pacific Region' , (Research report), Association of Pacific Rim Universities, University of Tokyo: Tokyo: Japan, 2010
Carnemolla, P. & C. Bridge	'Home Modifications and Their Impact on Waged Care Substitution' , Sydney: The University of New South Wales, 2010
Davy, L., Bridge, C., Judd, B., Flatau, P., Morris, A. and Phibbs, P.	'Age-Specific Housing for Low to Moderate-Income Older People' , AHURI Positioning Paper No 134, August 2010
Judd, B., Olsberg, D., Quinn, J., Groenhart, L. & Demirbilek, O.	'Dwelling, Land and Neighbourhood use by Older Home Owners' , AHURI Final Report No 144, March 2010
Jung, Y-M. & C. Bridge	'Rural Home Modification: Overview and Policy Issues' , Sydney: Home Modification Information Clearinghouse, Sydney: The University of New South Wales, 2010

Milligan, V., Phillips, R., Easthope, H. & Memmott, P.	'Service Directions and Issues in Social Housing for Indigenous Households in Urban and Regional Areas' , AHURI Positioning Paper No 130, June 2010
Travers, M., Phillips, R., Milligan, V. & Gilmour, T.	'Regulatory Frameworks and their Utility for the Not-for-Profit Housing Sector' , AHURI Positioning Paper No 127, April 2010

REFEREED CONFERENCE PRESENTATIONS

Bridge, C.	'UD and Australian Social Housing Policy: Are we there yet? 3rd International Conference for Universal Design' , ACT Hamamatsu, Honshu, Japan, 1st November 2010
Bridge, C.	'Using the House to fund Ageing in place: Benefits and Dangers Post Recession' , <i>Comparative Housing Research: Approaches and Policy Challenges in a New International Era</i> , OTB Research Institute and the Faculty of Architecture at Delft University of Technology in the Netherlands, 24-25 th March 2010
Bridge, C. & Elias, A-M.	'Future Proofing our Environments for an Ageing Population' , <i>3rd International Urban Design Conference: Designs on our Future</i> . Hoekwater, S. (Ed.) AST Management Pty Ltd. Southport BC, Qld. pp, 10-15, 2010
Bridge, C. Nuygen, T. & Plume, J.	'Virtual Environments for Access Design: Bringing together Multidisciplinary Teaching and Learning for Real World Outcomes' , Forsyth, Graham (Editor)., <i>CONNECTED 2010 International Conference on Design Education</i> , University of New South Wales, Sydney, Australia. pp, 190-194, 2010
Davison, G., Milligan, V. & Lawson J.	'The Role and Potential of Public Land Agencies in the Provision of Land for Affordable Housing' , 5th Australasian Housing Researchers Conference, Auckland New Zealand, 17-19 November 2010
Fishpool, J.	'Efficacy of Follow up Practices by Occupational Therapists in Rural and Remote Community Health' , <i>National SARRAH Conference 2010 9th National Rural and Remote Allied Health Conference: New Frontiers in Allied Health: Gathering Pearls of Wisdom</i> , Albury Entertainment Centre, Albury, 3-6 November 2010
Fishpool, J.	'Efficacy of Follow up Practices by Occupational Therapists in Rural and Remote Community Health' , 2nd Rural and Remote Health Conference. Cable Beach Club Resort and Spa, Broome, Western Australia, 20-22 October 2010.
Lawson, J., , Gilmour, T. & Milligan, V.	'After the Storm: Reflections on the Robustness of European Approaches to Channelling Private Investment Towards Affordable Rental Housing' , , ENHR Conference, Istanbul Turkey, 1-4 July 2010
Liu, E. & Pinnegar, S.	'Understanding People-Based Outcomes Experiencing Neighbourhood Renewal: a Case of Bonnyrigg, NSW' , Australasian Housing Researchers' Conference, 17-19 November 2010, Auckland NZ (refereed, paper to be published 2011 & under amended title)

Milligan, V. & Pawson, H.	'Transforming Social Housing in Australia: Challenges and Options' , ENHR Conference, Istanbul Turkey, 1-4 July 2010
Milligan, V. & Phibbs, P	'Building a Not-for-Profit Affordable Housing Industry in Australia' , <i>4th Australasian Housing Researchers' Conference</i> , 5-7 August 2009 (published 2010)
Randolph, B. & Tice, A.	'Unpacking the Demand for Higher Density Housing: An Analysis of Spatially Discontinuous Housing Sub-Markets in Sydney and Melbourne' , <i>4th Australasian Housing Researchers' Conference</i> , 5-7 August 2009 (published 2010)
Riazi, A., Boon M.Y., Dain S.J. & Bridge C.	'Difficulties in Reading Small Print Materials on Today's Home Appliances for People with Visual Impairment' , <i>Fourth International Convention for Rehabilitation Engineering & Assistive Technology</i> , Shanghai China, 21-23 July 2010
Riazi, A., Boon, M.Y., Dain, S.J. & Bridge, C.	'Suggestions for Adaptation to Vision Loss from Perspective of People with Macular Degeneration' , (Oral presentation). <i>10th International Conference on Low Vision</i> , Malaysia, 20 – 24 February 2010
Thompson, SM. & Capon, AG.	'Designing a Healthy and Sustainable Future: A Vision for Interdisciplinary Education, Research and Leadership' , Proceedings of <i>ConnectED 2010</i> , 2nd International Conference on Design Education, 28 June – 1 July, 2010, University of New South Wales, Sydney, Australia

OTHER CONFERENCE PRESENTATIONS

Bridge, C.	'Social Sustainability and Influence of the Built Environment on Quality of Life' , Keynote Presentation, <i>The Australian Association of Gerontology Rural Division Conference on 'Ageing at home: sustainable housing and communities for older people'</i> . Ballina RSL, Ballina, NSW, 15-16 April, 2010
Bridge, C.	'Aged-Specific Housing for Low to Moderate Income Older People' , Invited Presentation, <i>2010 ACS Northern Region Conference</i> , Armidale Return Services League Club, Armidale, 25 November 2010
Bridge, C.	'Dementia Friendly Environments' , Invited Presentation, <i>Dementia Collaborative Research Centre - Lab Meeting</i> , UNSW, 27 August 2010
Bridge, C.	'Reverse Mortgages and Older People Growth Factors and Implications for Retirement Decisions' , Invited Presentation, <i>AHURI Research Seminar Older people and housing: the latest evidence</i> . Art Gallery of South Australia, Adelaide, 28 September 2010
Capon, T.	'Healthy Planet, Places and People: Integrative Thinking for Creating Futures' , Keynote Presentation, <i>Creating Futures 2010: Harnessing creativity and social enterprise Conference</i> , 20 - 23 September 2010, Centre for Rural and Remote Mental Health, Queensland

Cunningham, D.	'Asking and finding at www.homemods.info ', Invited Presentation, 'Synergy' - <i>The 2010 biennial NSW HMMS State Conference</i> , Crowne Plaza, Lovedale Hunter Valley, 15 September 2010
Fishpool, J.	'Home Modification Follow-Up by Occupational Therapists: Consumer outcomes' , Invited Presentation, 'Synergy' - <i>The 2010 biennial NSW HMMS State Conference</i> , Crowne Plaza, Lovedale Hunter Valley, 15 September 2010
Judd, B., Bridge, C. & Olsberg, D.	'Housing and Older People' , (Symposium presentation), <i>International Federation on Ageing 10th Global Conference 2010 'Climate Change: Ageing into the Future'</i> . Melbourne Convention Centre, Melbourne, Victoria, 3rd -6th May 2010
Liu, E. & Easthope, H.	'Young Australians in Multigenerational Households: Trends, Drivers and Implications' , New Zealand Geographical Society Conference, Christchurch NZ, 5-8 July 2010
Milligan, V.	'Housing Challenges & the Influence of Housing Policy in Australia' , <i>APNHR Housing Conference</i> , Beijing China, 21-22 August 2010
Phillips, R & Milligan, V.	'Closing the Gap' on Indigenous Housing Disadvantage in Urban Areas: A Framework for Analysis of Current Social Housing Delivery Models , '5 th Australasian Housing Researchers' Conference, Auckland, November 17-19, 2010 (to be published in 2011)
Pinnegar, S., Randolph, B., Freestone, R. & Vizek, I.	'Suburban Reinvestment through 'Knockdown Rebuild' in Sydney' , <i>European Network for Housing Research Conference</i> , Istanbul, 4-6 July, 2009
Millikan, L.	'Small 'r' research to big 'R' Research in Home Mods: Building our Evidence' , Invited Presentation, 'Synergy' - <i>The 2010 biennial NSW HMMS State Conference</i> , Crowne Plaza, Lovedale Hunter Valley, 14 September 2010
Olsberg, D., Howe, A. & Bridge, C.	'Critical Research Issues in Housing for Older People' , Presidential Address, <i>Australian Association of Gerontology, 43rd National Conference Islands of Ageing: Building Bridges for people, policy and practice</i> , Hotel Grand Chancellor, Hobart, Tasmania, 17 November 2010
Randolph, B.	'Socially Sustainable Higher Density: Plenty of Questions, Not Many Answers' , Keynote speaker, <i>Australasian Housing Researchers Conference</i> , Auckland, 17-19 November 2010
Randolph, B., Pinnegar, P. & Tice, A.	'The Impact of the First Home Owner Boost in Australia: An effective response to the global financial crisis?' , <i>European Network for Housing Research Conference</i> , Istanbul, 4-6 July, 2010
Thompson, SM.	'New Ways of Working: The NSW Healthy Built Environments Program' , Keynote Presentation, <i>2010 Healthy Cities Conference</i> , Brisbane on 12 – 13 July 2010
Thompson, SM.	'On My Walk: An Exploration of People and Environment Connections through the Act of Walking' <i>Biennial Conference in Philosophy, Religion And Culture - Creation, Nature and the Built Environment</i> , 3 October 2010, Sydney
Wiesel, I.	'A Social Justice Perspective on Affordable Housing' , <i>International Geographers Union Conference: Bridging Diversity in a Globalised World</i> , Tel Aviv, Israel, 10 July 2010

COMMUNITY AND PRACTICE PRESENTATIONS

Bridge, C., Carnemolla, P., Walcot, K., Millikan, L., Cunningham, D. & Jung, Y.M	'Synergy' - The 2010 biennial NSW HMMS State Conference , Home Modification Information Clearinghouse Trade Display, Crowne Plaza, Lovedale Hunter Valley, 14-15 September 2010
Bridge, C. & Walcot, K.	'Falls Prevention' , NSW Falls Prevention Network Meeting, Mathews Theatres and Pavilions at UNSW, 23 rd June 2010
Capon, T.	'Climate Change and Health' Keynote Presentation, <i>NSW Climate Change Science Research Network</i> , 20 April 2010
Capon, T.	'Mobility from a Health and Sustainability Perspective' , Keynote Presentation, <i>ACT 'Active Living Forum'</i> , 6 August 2010
Capon, T.	'Sustainability: An Opportunity for Health Promotion' , Keynote Presentation, <i>Australian Health Promotion Association</i> , 21 April 2010
Capon, T.	'Transport and Health: Sustainability, Equity and Wellbeing' , Keynote Presentation, <i>Healthy Cities Onkaparinga Community Forum</i> , 7 July 2010
Milligan, V.	'The Affordable Housing Model: Policy and Practice' , <i>SGS Seminar, Alternative Housing Models</i> , 8 June 2010
Milligan, V. & Lawson, J	'International Financing Models for Affordable Housing' , <i>National Affordable Housing Exchange</i> , Sydney, 18-19 February 2010
Pinnegar, S.	'Regenerating Estates: Setting the Context and Scoping the Task' , Shelter NSW conference: <i>Estates in the Balance</i> , Sydney, 17 June 2010
Randolph, B.	'Living with Density: Plenty of Questions, Not Many Answers' , Keynote Speaker, <i>NSW Shelter Conference on Higher Density Housing</i> , 2 December, Sydney.
Randolph, B.	'Moving beyond numbers: Planning Challenges for the 21st Century Australian City' , Keynote speaker, <i>Planning Institute of Australia National Awards for Planning Excellence</i> , Canberra, 26 March. (Invited speaker)
Randolph, B.	'The Spatial Debate – Sydney at 7 Million' , Plenary speaker and panel member at the <i>Great Growth Symposium</i> , Property Council of Australia – NSW, Sydney 5 November (invited speaker).
Randolph, B.	'Urban Consolidation: A task to hard for planning?' , Utzon Lecture, Faculty of the Built Environment, UNSW, 16 June
Randolph, B.	'Urban Renewal and affordable housing: The search for the missing link' , Built Environment Design Professions Seminar <i>Affordable Housing: A hard nut to crack, but one worth cracking</i> , Sydney, (Invited speaker).
Randolph, B.	'Urban Consolidation: A Challenge Beyond Planning' , Australian Institute of Urban Studies, NSW Division, Sydney, 29 September (invited speaker).
Randolph, B.	'Vision for the community housing sector in the next five years' , Plenary speaker and panel member at the <i>2010 NSW Community Housing Conference</i> , Newcastle, 10 November

Randolph, B. & Pinnegar, S.	'Transforming concentrations of disadvantage: Evidence and approaches' , Presentation to NSW Treasury. 10 December, Sydney. (Invited speaker).
Thompson, SM.	'Health and Planning - Rejuvenating the Relationship' , Keynote Presentation, <i>NSW Healthy Weight Network</i> , 16 March 2010
Thompson, SM.	'Healthy Built Environments: Linking Contemporary Policy, Research and Action in a Cross-Disciplinary Course for Post Graduate Students in the Built Environment and Health' Invited Presentation, Built Environment Faculty Learning and Teaching Seminar on 16 September 2010
Thompson, SM.	'Healthy Built Environments Program' , Keynote Presentation, <i>Parks and Leisure Australia</i> , 30 June 2010
Thompson, SM.	'Healthy Communities' , Keynote Presentation, <i>Australasian Place Leaders Association</i> , Sydney on 8 – 10 September 2010
Thompson, SM.	'The Delivery of Healthy Built Environments' , Invited Presentation, <i>Sydney SW Area Health Service's 'Healthy Urban Development Strategic Planning and Action Group' (SPAG)</i> , 8 September 2010
Thompson, SM. & Capon, T.	'Healthy Built Environments = Healthy Cities' , Invited Public Lecture, <i>UNSW Faculty of the Built Environment Utzon Lecture Series</i> , 13 October 2010
Wiesel, I.	'New Directions in Provision of Social and Affordable Housing in Australia: The Implications for People with Intellectual Disability' , <i>Fifth Annual Roundtable on Intellectual Disability Policy</i> , 3 December, 2010



7

CONFERENCES AND SEMINARS

7 CONFERENCES AND SEMINARS

1. 2010 BE RESEARCH SEMINAR SERIES, Semester 2 2010

The first series of the BE Research Seminars have now been successfully completed in Session 2, 2010. City Futures took a lead role in developing and organising the 2010 Built Environment Research Seminars series as part of the Centre's growing integration with the Faculty.

The seminar series was held aiming to provide a forum for researchers to present and discuss new and ongoing research, and to identify possible areas of collaboration with Faculty and University colleagues.

The research seminar series consisted of 11 individual lunch time seminars:

Date	Speaker	Topic
21 July 2010	Jim Plume	'UrbanIT: Integrating BIM and GIS Technologies to Support the Planning, Design, Construction and Management of the Urban Environment'
2 August 2010	Dr Peter Graham	'Climate Change'
17 August 2010	Prof Mark Tewdwr-Jones	'Governing London: Challenging Times for an Evolving Planning Landscape'
25 August 2010	A/Prof Susan Thompson	'Bringing Health into the Built Environment: An Overview of the Healthy Built Environments Program'
30 August 2010	Paul Osmond	'Hemispherical Photography as a Tool for Urban Sustainability Evaluation and Design'
13 September 2010	A/Prof Harry Margalit	'Urban Form and Energy: How Big, How Much?'
20 September 2010	A/Prof Catherine Bridge	'Future-Proofing our Environments for an Ageing Population'
29 September 2010	Barry Webb	'Day, Night and Dark Sky Imagery. A Public Space Lighting Project'
6 October 2010	Dr Tom Loveday	'Memorial: Paintings from the Holocaust Memorial, Berlin'
11 October 2010	Vivian Chow	'Preparing Hospitals for Extreme Weather Events Caused by Climate Change'
20 October 2010	Prof Andy Dainty, Loughborough University	'Sustaining Construction Competitiveness'

We hope to make to BE Research Seminars a regular component of the Faculties activities.



2. The History of Public Housing in Australia

28 October 2010

Visiting Professor Patrick Troy AO presented at an internal seminar the outlining of his current work on the history of public housing in Australia.



8

TEACHING AND SUPERVISION

8

TEACHING AND SUPERVISION

While City Futures is first and foremost a research centre, many members of the team contribute to teaching and supervision in the Faculty. As research becomes increasingly integrated with teaching across the disciplines in the Faculty, our skills, resources and of course the wealth of research material as well as ongoing research opportunity will provide an excellent platform.

Alongside an extensive contribution of PhD and Master's supervision, City Futures is responsible for the Master of Planning Major Project Course. This 12 UOC course provides students with an introduction to the research process, enabling them to design a research project, conduct some empirical research and prepare a report. The course runs each semester and students typically carry out their projects in the final semester on the MPLAN course. Members of the team also contribute to supervision of students undertaking their BPLAN theses in Semester 2.

City Futures are coordinating the following three courses:

MPLAN 7122 Planning project, Project design, methods and supervision of student research projects

Course coordinator: Dr Simon Pinnegar

The aim of this course is to coach students through the process of conducting an independent research project, so as to provide insight into how research is scoped, negotiated and applied in professional practice. The course involves the production of a minor dissertation on a topic of the students' choice. It seeks to provide students with the opportunity to conduct applied research into an area of personal interest in planning and/or relevance to planning practice. Students gain an understanding of the conceptual, methodological, and technical bases for the development and delivery of research projects. Each student is personally supervised by an academic staff member of the Faculty. The principal output of the course is a research paper of 8,000-10,000 words in length.

BENV7712 Healthy Built Environments

Course coordinator: A/Prof Susan Thompson

Healthy Built Environments is a post graduate elective that focuses on the role of the built environment in supporting healthy behaviour for diverse communities. The course examines the ways in which health and built environment professionals are collaboratively addressing the epidemic of chronic disease associated with sedentary and socially isolated urban living. Current research, legislative and policy frameworks, together with best practice from Australia and abroad, are critically evaluated. The challenges of inter-disciplinary research, policy development and implementation are considered. This course is specifically designed for students undertaking post graduate studies in built environment and health and is closely aligned to the Healthy Built Environments Program @ the City Futures Research Centre. Classes involve a mixture of lectures, participant discussion and critical review, hands-on experience with different tools, and a group presentation and debate.

BENV2949 Healthy Planning

Course coordinator: A/Prof Susan Thompson

Healthy Planning is an inter-disciplinary elective for senior students studying to be built environment and health professionals. The course focuses on the ways in which built, natural and socio-cultural environments inhibit on the one hand, and on the other, can enhance and sustain the physical and psychological health of

contemporary communities. The course will focus on the relationship between the urban environment and current health issues facing modern society-particularly life style related health problems such as obesity and depression, Research and theoretical issues which draw planning and health together will be discussed using specific case studies. Sessions will involve a mixture of lectures, participant discussion, presentations and strategic engagement with healthy planning tools.

SUPERVISION OF PHD STUDENTS

Name of Student	Topic	Supervisor
Samira Abbasalipour	Approaching Shopping Centres: The successful interface between shopping centres and surrounding urban space	Dr Bruce Judd & Dr Gethin Davison*
Wenji Cai	Housing Affordability in Wuhan: A Comparative Study	Prof Bill Randolph & Dr Vivienne Milligan*
Jason Yi-Kai Chuang	Healing landscapes for those with Spinal Cord Injury	A/Prof Linda Corkery & A/Prof Catherine Bridge*
Robyn Conroy	Peeling the onion: understandings of heritage in the layered suburban cultural landscape	A/Prof Susan Thompson & Prof Rob Freestone#
Jenny Fishpool	Home visiting follow-up of Home Maintenance and Modification Services	A/Prof Catherine Bridge Dr Oya A/Prof Catherine Bridge Demirebilek & A/Prof Bruce Judd*
Tinalee Gallico	Beyond sustainable Development; Governance & Community for ecologically positive regeneration	Dr Simon Pinnegar and Prof Bill Randolph*
Shane Geha	Development of an Empirical Model for the Quantification of the Rezoning Effect	Peter Williams & Prof Bill Randolph*
Lucy Groenhart (APAI) (Awarded PhD 2010)	Social Cost Benefit Analysis of Public Housing Estate Regeneration in NSW	Prof Bill Randolph & Dr Simon Pinnegar*
Tracie Harvison	Universities and Positive Ageing: Emerging Modes of Engagement for an Ageing Society	Dr Bruce Judd & Dr Christine Steinmetz*
Helen Kendall	Integrated landscapes for ageing well in the urban environment: an Australian perspective	A/Prof Susan Thompson & A/Prof Linda Corkery#
Jennifer Kent (nee Manefield)	Commuting using cycling to access public transport – benefit, barriers and the built environment	A/Prof Susan Thompson & Dr Simon Pinnegar#

Lydia Kirkoff	Urban Socio-cultural Development in the context of the Creative Industries in Auckland	Prof Bill Randolph & Prof Rob Freestone*
Bartholomew Maiorana (APAI)	Can an ontology of Christopher Alexander's theory of harmony-seeking computations be developed to assess the impact upon wholeness-extending digital architecture in an urban context?	Jim Plume & Dr Jack Barton*
Kirsty Mate	The Future of Sustainability & Retail Design in Australia	Dr Simon Pinnegar & Prof Stephen Loos (UTAS)*
Louise McKenzie	Climate, public space and public health: the influence of heat on public space use and implications for public health – a Western Sydney Case Study	A/Prof Susan Thompson & Dr Robert Samuels#
Aida Morden (Awarded PhD 2010)	Social Dynamics of the Landlord-Tenant Relationship: Litigations in Public Housing	Prof Bill Randolph & A/Prof Bruce Judd*
Bernadette Pinnell (APAI)	Establishing an evaluation framework to measure the Impact of public housing estate renewal in NSW on the areas surrounding the estate; using GIS as a tool for communicating the impact of the regeneration	Prof Bill Randolph & Dr Simon Pinnegar*
Abbas Riazi	Perspectives of people with macular degeneration and their service providers on home modification and assistive devices	Dr Mei Ying Boon (School of Vision Sciences,) & A/Prof Catherine Bridge*
Joanne Quinn	Design of the Home Environment for the Ageing Population	Dr Oya Demirbilek & A/Prof Bruce Judd*
Cathy Sherry	Significance of Strata and Community Title	Prof Brendan Edgeworth & Prof Bill Randolph*
Gary Shields	Planning for Ageing: A healthy lifestyle And Built environment	A/Prof Susan Thompson & Prof Bill Randolph*
Andrew Tice	The Role and Function of Lower Value Housing Markets	Prof Bill Randolph & Dr Simon Pinnegar#
Jing Xie	Mixed-Use Communities	Prof Xing Ruan & Dr Simon Pinnegar*
Ting Xu (Awarded PhD 2010)	Housing differentials in sub-districts of Shenzhen, China: a geo-spatial analysis from profiles of house price, house types and households	Prof Peter Murphy & Prof Bill Randolph*

#Joint Supervisor; *Co-Supervisor

SUPERVISION OF MASTERS BY RESEARCH STUDENTS

Jenny Fishpool	Home visiting follow-up of Home Maintenance and Modification Services	A/Prof Catherine Bridge, Dr Bruce Judd * and Dr Oya Demirbilek*
Sarah Hudson	Dire Stratas	Prof Bill Randolph and Peter Williams*

* Co-Supervisor

TEACHING

A/Prof Catherine Bridge

Session 1:

- IDES1031-6 UOC 90th percentile design and inclusive design issues. Invited lecture for 2nd Year Industrial Design Studio 1 for Steve Ward
- PLAN3015-6 UOC *Social Planning: What role does the built environment play in the experience of disability?*
- BENV2949-6 UOC Inclusive planning and social sustainability. Invited lecture for Healthy Planning Summer School 2009-10 for Susan Thompson

Dr Gethin Davison

Session 2:

- MPLAN 7122 Planning project, Project design, methods and supervision of student research projects

Dr Hazel Easthope

Session 1:

- MPLAN 7122 Planning project, Project design, methods and supervision of student research projects (Co-lecturer)
- Supervised two MPLAN7122 Planning Project students
- Supervised two PLAN4132 BPLAN Thesis students
- BENV2986 Property and Asset Management (Guest lecture for the undergraduate course)
- GEOS1601 Australian and Global Geographies: Integration and Divergence, School of Biological, Earth and Environmental Sciences at UNSW - Lectured a module (3 lectures) of a 1st year geography course.

Session 2:

- MPLAN 7122 Planning project, Project design, methods and supervision of student research projects (Co-lecturer)
- Supervised two MPLAN7122 Planning Project students
- Supervised two PLAN4132 BPLAN Thesis students

A/Prof Bruce Judd

Session 1:

- ARCH 7112/7113 Architectural Design Studio (M.Arch Program)
5 weeks x 2 hrs per week

Summer Term, 2010/11:

- UDES0003 International Urban Design Studio – Portland Oregon Project

Dr Edgar Liu

Session 2:

- MPLAN 7122 Planning project, Project design, methods and supervision of student research projects

Dr Simon Pinnegar

Session 1:

- MPLAN 7122 Planning project, Project design, methods and supervision of student research projects (Course coordinator)
- BPLAN4031 Research Design (Guest course lecture)

Session 2:

- MPLAN 7122 Planning project, Project design, methods and supervision of student research projects (Course coordinator)
- BPLAN4132 5th year thesis supervision and marking

A/Prof Susan Thompson

Session 1:

- BENV2949 Healthy Planning (Course Coordinator)
- MPLAN 7122 Planning project, Project design, methods and supervision of student research projects – supervised 2 students
- HESC3504 Physical Activity & Health (Guest Lecture)
- PLAN1241 Planning Theory and Practice (Guest Lecture)

Session 2:

- BENV7712 – Healthy Built Environments - Course Co-ordinator
- MPLAN 7122 Planning project, Project design, methods and supervision of student research projects – supervised 2 students
- BPlan Thesis – supervised 3 students

Dr Ilan Vizel

Session 1:

- MPLAN 7122 Planning project, Project design, methods and supervision of student research projects



Session 2:

- MPLAN 7122 Planning project, Project design, methods and supervision of student research projects

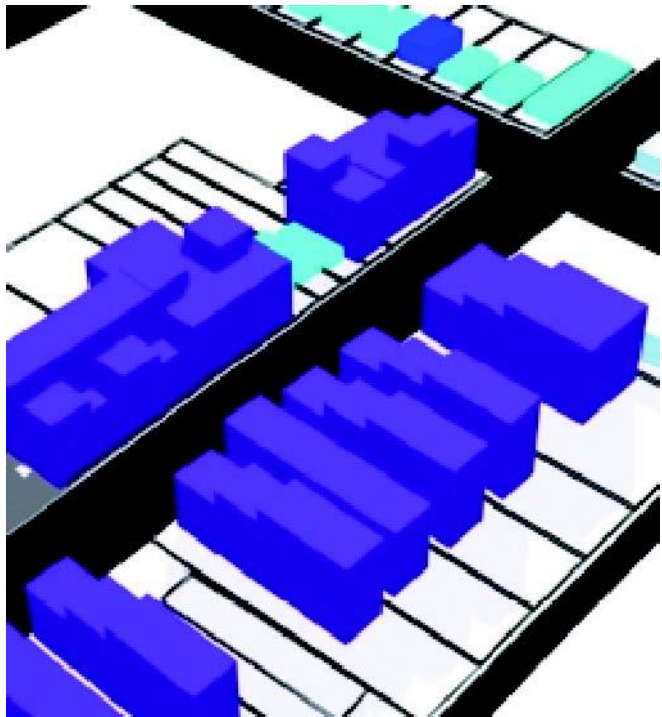

9

STATEMENT OF FINANCIAL PERFORMANCE

9 STATEMENT OF FINANCIAL PERFORMANCE

OVERVIEW

With the incorporation of Healthy Built Environments Program and Home Modification Information Clearing House, both the Centre's income and expenditures did increase significantly throughout 2010. The combined Centres financial result for the year reflects a strong growth trajectory, building on the position achieved by the Centre during its previous years of operation. A surplus of 686,700 was brought forward at the beginning of the year.

Over the year, new external research funding totalling \$2,090,782.06 was received. Strategic funding from the Office of the DVC (Research) consisted of \$258,494 cover A/Prof Vivienne Milligan and parts Dr Simon Pinnegar's salary costs as well as UNSW's 50% share of the 2010 Annual AHURI fee as lead participant of the UNSW/UWS AHURI Centre. City Futures did also receive strategic funding \$9,500 being for Faculty of Engineering's Contribution to the National Climate Change Adaptation Research Facility. Built Environment provided \$140,358 to the Centre for Early Career Researcher Grant, DEST bonuses and other support.

Expenditures for the year totalled \$1,760,854.70 of which Centre Staff salaries totalled \$1,101,779.95. This figure is not including Prof Bill Randolph's salary, A/Prof Catherine Bridge A/Prof Susan Thompson's salaries, which are underpinned by the Faculty. Cost of materials; \$540,023.47, included the annual AHURI membership fee of \$121,900 exclusive of GST, 50% of which was reimbursed from University of Western Sydney.

The net operating result showed a surplus of \$707,983.73 for the year, which, when added to the surplus brought forward from 2009, led to a final carry forward of 1,251,445.77 to 2011.

STATEMENT OF IN-KIND CONTRIBUTIONS

City Futures Research Centre is occupying offices on level one and level three in the Red Centre (west wing). The Centre does also receive in-kind contributions from the Faculty in the form of support from IT and Finance staff.

STATEMENT OF FINANCIAL PERFORMANCE 2010 CITY FUTURES

1 Jan to 31 Dec 2010

	2010		2009
	Total		Total
	\$		\$
Income			
External Funds *	964,538.93	ii)	1,282,348.79
Internal Funds	378,056.38		334,047.19
Total Income	1,342,595.31		1,616,395.98
Expenses			
Payroll	839,897.18		908,162.52
Equipment	12,585.89		15,333.93
Materials	187,985.55	i)	481,826.47
Travel	62,882.07		55,398.64
Total Expenses	1,103,350.69		1,460,721.56
Operating result for the period	239,244.62		155,674.43
Surplus(Deficit) Bfwd from Prior Period	518,876.38	iii)	363,227.09
Retained Funds Surplus(Deficit)	758,121.00		518,901.52
* Excludes debtors (unpaid invoices)	48,675.00		

Notes to the Statement of Financial Performance

- i) 2010 Annual AHURI fee as lead participant \$121,899.78 (50% has been reimbursed from UWS)
- ii) 50% 2011 AHURI annual membership fee received in 2010 from UWS
- iii) Discrepancy of \$25.14 between 2009 closing balance and 2010 opening balance occurred due to Debtors GST Input Tax

STATEMENT OF FINANCIAL PERFORMANCE 2010 HEALTHY BUILT ENVIRONMENTS PROGRAM

1 Jan to 31 Dec 2010

	Total
	\$
Income	
External Funds *	563,618.00
Internal Funds	0.00
Total Income	563,618.00
Expenses	
Payroll	123,069.00
Equipment	4,403.76
Materials	142,667.50
Travel	9,034.10
Total Expenses	279,174.36
Operating result for the period	284,443.64
Surplus(Deficit) Bfwd from Prior Period	0.00
Retained Funds Surplus(Deficit)	284,443.64
* Excludes debtors (unpaid invoices)	82,500.00

STATEMENT OF FINANCIAL PERFORMANCE 2010 HOME MODIFICATION INFORMATION CLEARINGHOUSE

1 Jan to 31 Dec 2010

	Total
	\$
Income	
External Funds *	562,625.13
Internal Funds	0.00
Total Income	562,625.13
Expenses	
Payroll	138,813.77
Equipment	4,048.52
Materials	209,370.42
Travel	26,069.39
Total Expenses	378,329.65
Operating result for the period	184,295.48
Surplus(Deficit) Bfwd from Prior Period	24,585.66
Retained Funds Surplus(Deficit)	208,881.14
* Excludes debtors (unpaid invoices)	0.00



STATEMENT OF FINANCIAL PERFORMANCE 2010 TOTAL CITY FUTURES RESEARCH CENTRE (CF, HBEP & HMInfo)

1 Jan to 31 Dec 2010

	2010 Actual Total \$	Budget YTD \$	Variance \$
Income			
External Funds *	2,090,782.06	943,921.00	1,146,861.06
Internal Funds	378,056.38	379,095.00	-1,038.62
Total Income	2,468,838.44	1,323,016.00	1,145,822.44
Expenses			
Payroll	1,101,779.95	938,646.00	163,133.95
Equipment	21,038.17	15,333.93	5,704.24
Materials	540,023.47	544,510.00	-4,486.53
Travel	98,013.11	58,168.00	39,845.11
Total Expenses	1,760,854.70	1,556,657.93	204,196.77
Operating result for the period	707,983.73	-233,641.93	
Surplus(Deficit) Bfwd from Prior Period	543,462.04	518,876.38	
Retained Funds Surplus(Deficit)	1,251,445.77	285,234.45	
* Excludes debtors (unpaid invoices)	131,175.00		

Notes to the Statement of Financial Performance

- i) The significant variance between the 2010 budget and the actual figures incurred due to the two new Research Programs; Healthy Built Environments Program, and Home Modification Information Clearinghouse being incorporated into City Futures Research Centre.